

MUTO Premium & Comfort

Manual sliding
door system



Majoring in convenience

User-friendly models and options, individually configurable systems

Extraordinary convenience housed in a slim profile

The MUTO system impresses by virtue of its compact elegance and extensive functionality, creating a sliding door system with enhanced user-friendliness.

Even tailored solutions come easily

The fully integrated MUTO offers a choice of models and optional functions, all controlled by mechanisms housed out of sight behind the compact header. The XL 120 Self-Closing model offers the convenience of power-free self-closing, including DORMOTION at end of closing cycle and DORMOTION as an option in opening cycle (add option DMSC).

Optional convenience feature

A convenient option is the MUTO status indicator, which allows the door position to be monitored from anywhere in the building.

Glass, wood, or metal applications

MUTO is particularly suitable for glass applications, but can be adapted for wood, metal, or other door material solutions.

ADA compatibility

MUTO systems are ADA compatible with or without DORMOTION (DM), except for XL 120 SC. Note that, as with traditional swing doors, the force required to disengage from the DM latch and set the door in motion is not included in the measurement when meeting the required 5 lb opening force.

Self-closing – hassle-free



The MUTO Premium XL 120 Self-Closing model automatically closes the door once it has been opened; the quiet action operates without a power supply – an enhancement to any interior.

DORMOTION – the elegant Softclose® damping mechanism



The epitome of elegant convenience, the optional DORMOTION function gently decelerates the door panel over the last few inches, taking it automatically and quietly to its end opened or closed position.

Status indicator – everything under control



The optional status indicator ensures that the sliding door can be monitored with remarkable ease. As soon as the door opens or closes, a status signal is transmitted to the building management system or an indicator lamp – an important benefit in buildings requiring professional facility management capability.

Model comparison guide

Note: All measurements are shown in inches (mm) – example: 3/8" (10).

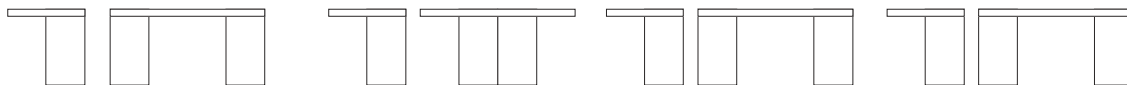

Description	MUTO Premium XL 150 DORMOTION (DM)	MUTO Premium XL 150	MUTO Premium XL 80 DORMOTION (DM)	MUTO Premium XL 120 Self-Closing ³
Track dimensions (less cover)	w = 2-3/4" (70) h = 2-23/32" (69)	w = 2-3/4" (70) h = 2-23/32" (69)	w = 2-3/4" (70) h = 2-23/32" (69)	w = 3-7/8" (98) h = 2-23/32" (69)
Track dimensions + cover profile ¹	w = 2-27/32" (72) h = 2-23/32" (69)	w = 2-27/32" (72) h = 2-23/32" (69)	w = 2-27/32" (72) h = 2-23/32" (69)	w = 3-15/16" (100) h = 2-23/32" (69)
Track dimensions + optional sidelite extrusion + cover ²	w = 3-19/32" (91)	w = 3-19/32" (91)	w = 3-19/32" (91)	w = 4-11/16" (119)
Description				
Glass thickness	5/16"–9/16" (8–13.5)	5/16"–9/16" (8–13.5)	5/16"–9/16" (8–13.5)	5/16"–9/16" (8–13.5)
Max wood door thickness	1-31/32" (50)	1-31/32" (50)	1-31/32" (50)	1-31/32" (50)
Door height	≤ 118" (3 m)	≤ 118" (3 m)	≤ 118" (3 m)	≤ 118" (3 m)
Min door width (glass or wood)	40-1/8" (1020)	26" (660)	31-7/8" (810)	34" (864)
Max glass door width	57" (1448)	57" (1448)	57" (1448)	57" (1448)
Max wood door width	60" (1524)	60" (1524)	60" (1524)	60" (1524)
Door height adjustment	+/- 3/16" (+/- 5)	+/- 3/16" (+/- 5)	+/- 3/16" (+/- 5)	+/- 3/16" (+/- 5)
Max door weight/one door	330 lb (150 kg)	330 lb (150 kg)	176 lb (80 kg)	264 lb (120 kg)
Max door weight/two doors	2 × 330 lb (150 kg)	2 × 330 lb (150 kg)	2 × 176 lb (80 kg)	2 × 264 lb (120 kg)
Clearance between door & wall (glass)	25/32" (20)	25/32" (20)	25/32" (20)	25/32" (20)
Clearance between door & wall (wood)	9/32" (7)	9/32" (7)	9/32" (7)	9/32" (7)
Mounting options	Wall, ceiling (surface or recessed), or glass transom/fixed panel	Wall, ceiling (surface or recessed), or glass transom/fixed panel	Wall, ceiling (surface or recessed), or glass transom/ fixed panel	Wall, ceiling (surface or recessed), or glass transom/fixed panel
25% faster installation	●	●	●	—
Wood door kit available	○	○	○	○
Tempered Laminated Glass (TLG) kit available	○	○	○	○
Functions				
DORMOTION	● Std	○	● Std	● Closing cycle std ³ ○ Opening cycle optional (DMSC)
Synchro (synchronized opening and closing of pairs)	—	○	—	—
Status indicator	○	○	○	○
Self-closing	—	—	—	● Std

● yes — no ○ optional

Note: Dimensions are in inches, with millimeters as the benchmark.

¹Track dimensions
+ cover profile

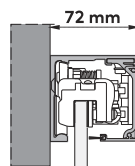

²Track dimensions
+ optional sidelite
extrusion + cover

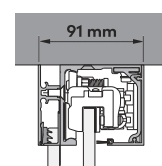

Installation types

Installations

Disclaimer

When sizing MUTO door panels, maximum weight capacity is key. When maximizing door panel width, height, or thickness, one or more of the other dimensions (width, height, or thickness) will require reductions to remain at or below the maximum allowable weight capacity of the specific MUTO sliding unit, within industry codes, standards, or specifications, and within door manufacturer recommendations.

Actual track, cover, and/or other MUTO extrusion profile inventory lengths are 157-1/2" (4 m) for all Make-To-Order (MTO) units. All extrusion includes clamp marks visible within 1/2" (12) to 1-1/2" (38) from each end of all profiles. Clamp marks need to be cut off in the field for any full length profile shipped, with the exception of CE-R units. Please take into consideration when planning system lengths and list price charges. MTO systems other than CE-R will be fabricated at the factory with a joint at center for systems exceeding 154" (3.9 m), or 157" (4 m) for CE-R and charged accordingly with a per FT. list price add.

With one sliding panel

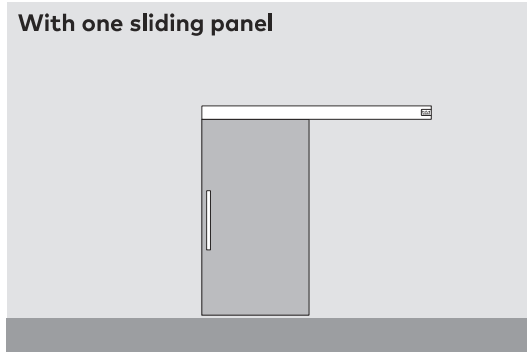

With two sliding panels

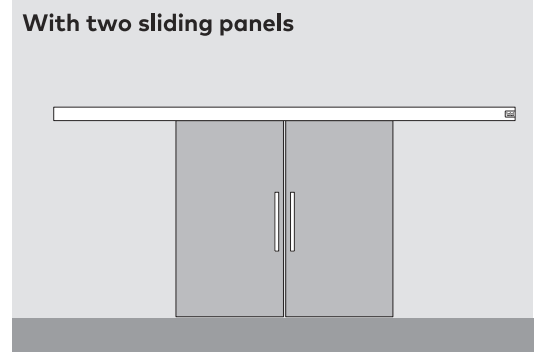

Mounted to wall

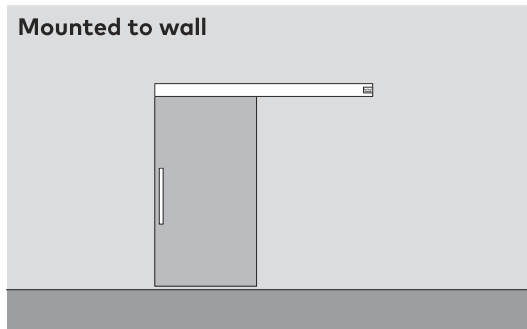

Mounted to ceiling with optional fixed panel (sidelite)

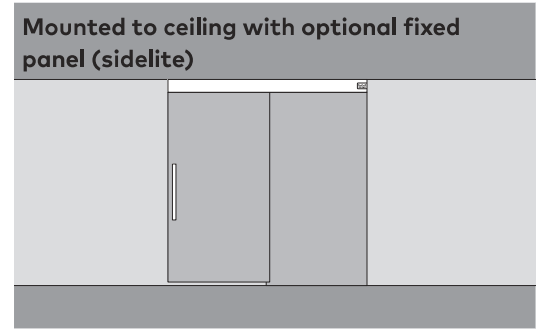

Mounted recessed in ceiling with optional fixed panel (sidelite)

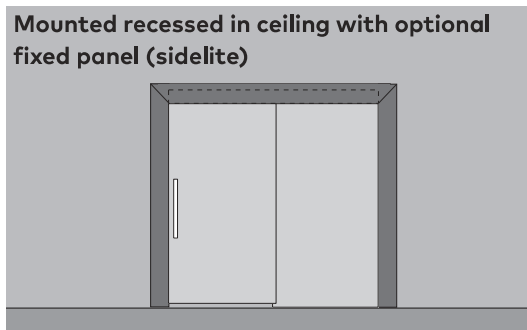

Mounted to glass fixed panels (sidelites) & transom

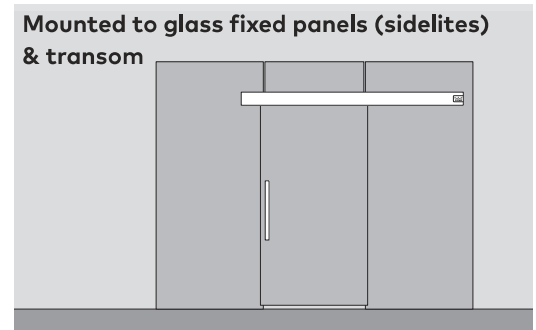

Functions

Synchro function

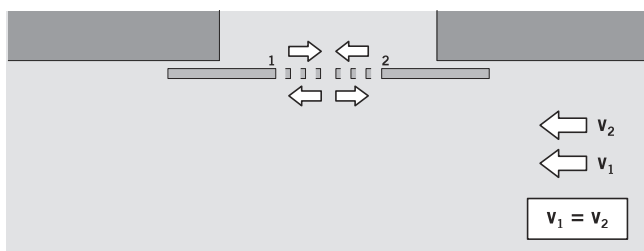
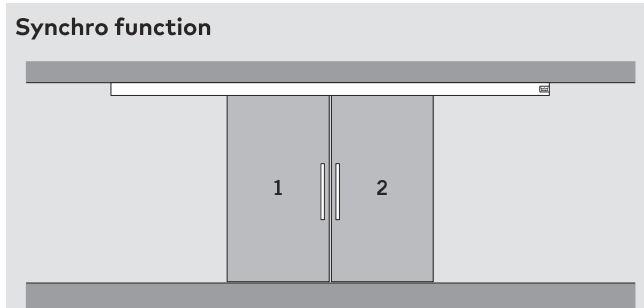

Telescopic function

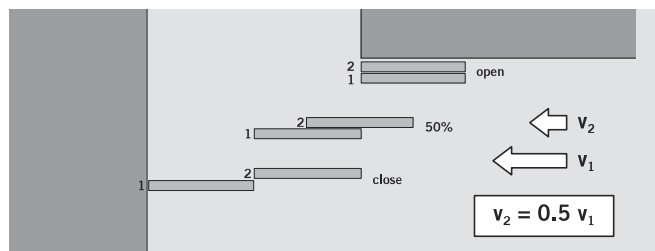
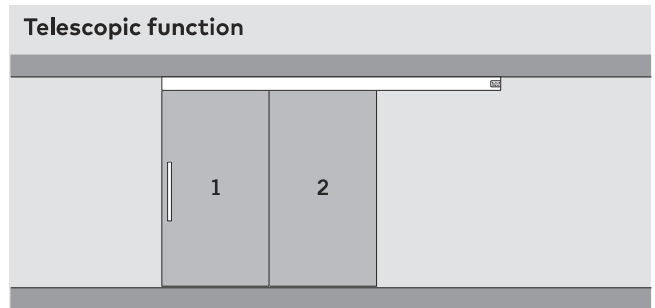

Installation made easy

Cover profile

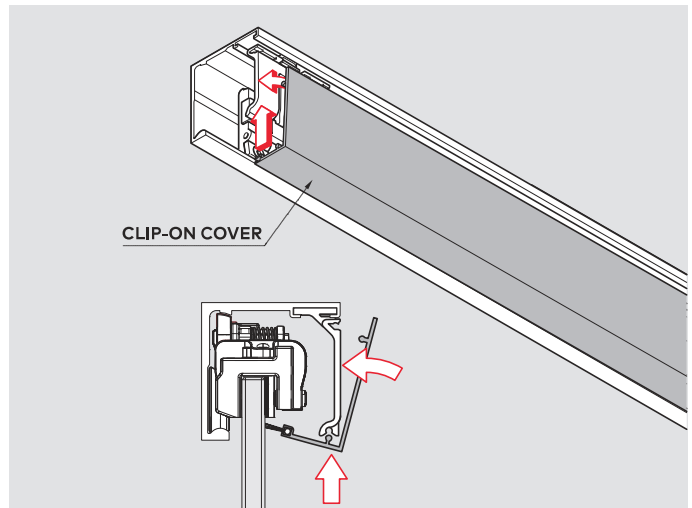
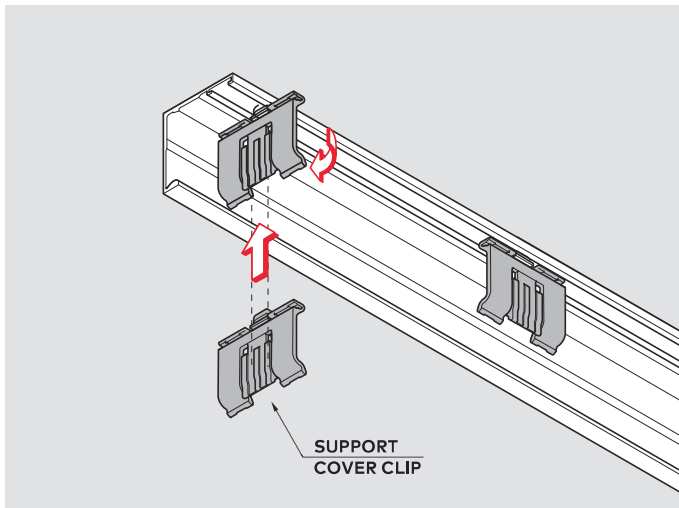

Anti-jump device

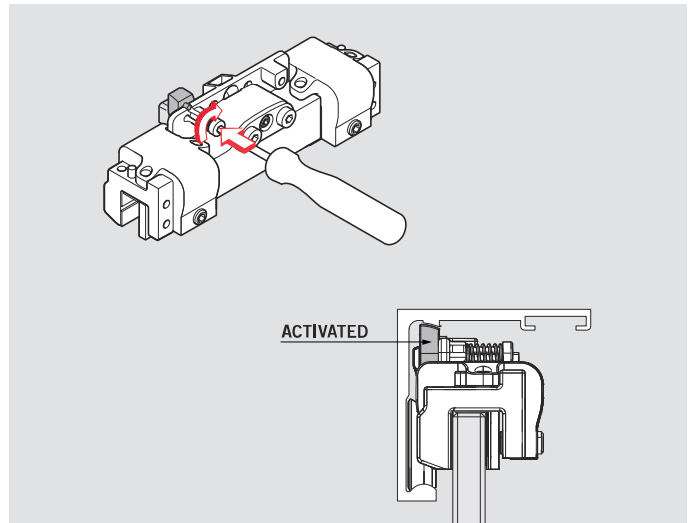
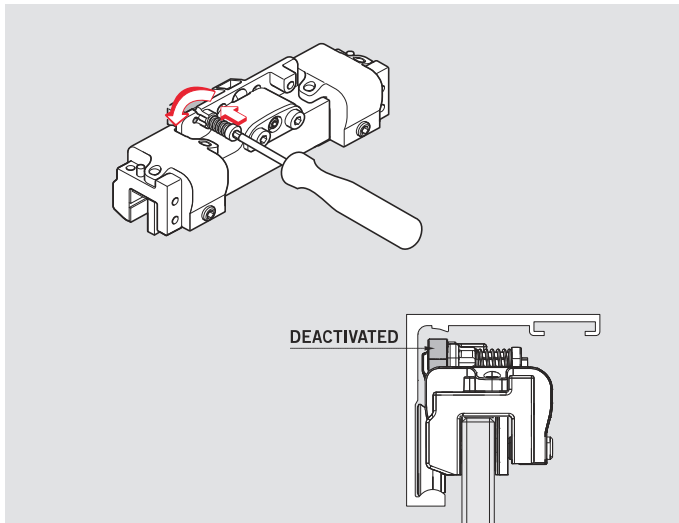

Height adjustment

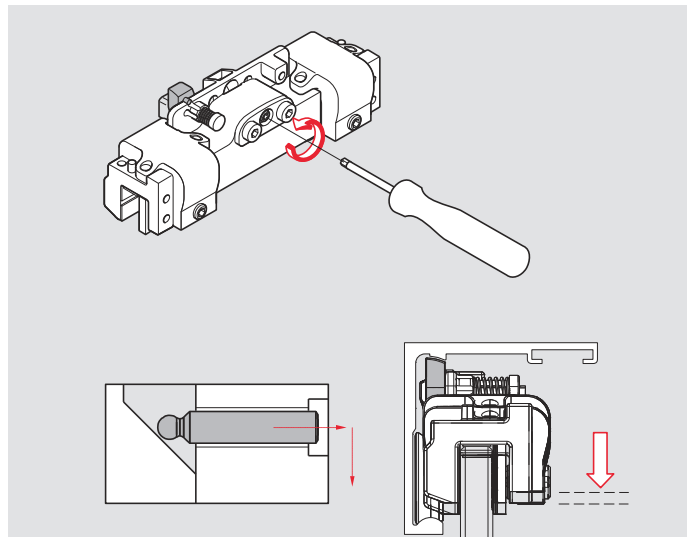
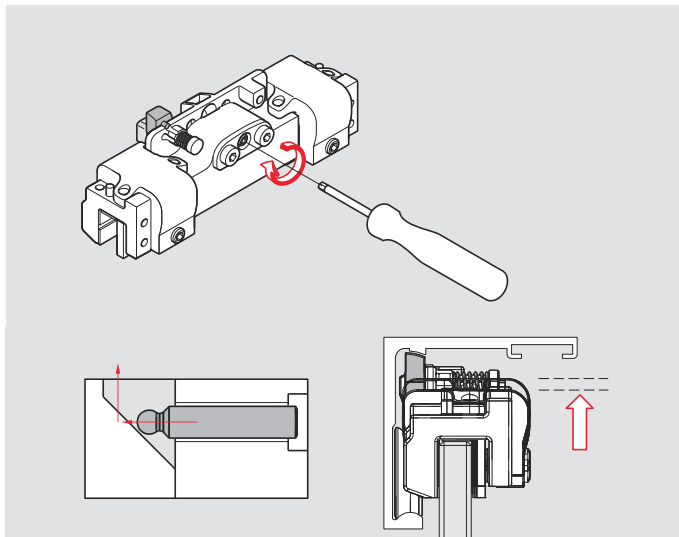

Installation for ceiling recessed (CE-R) mount only

Cover profile

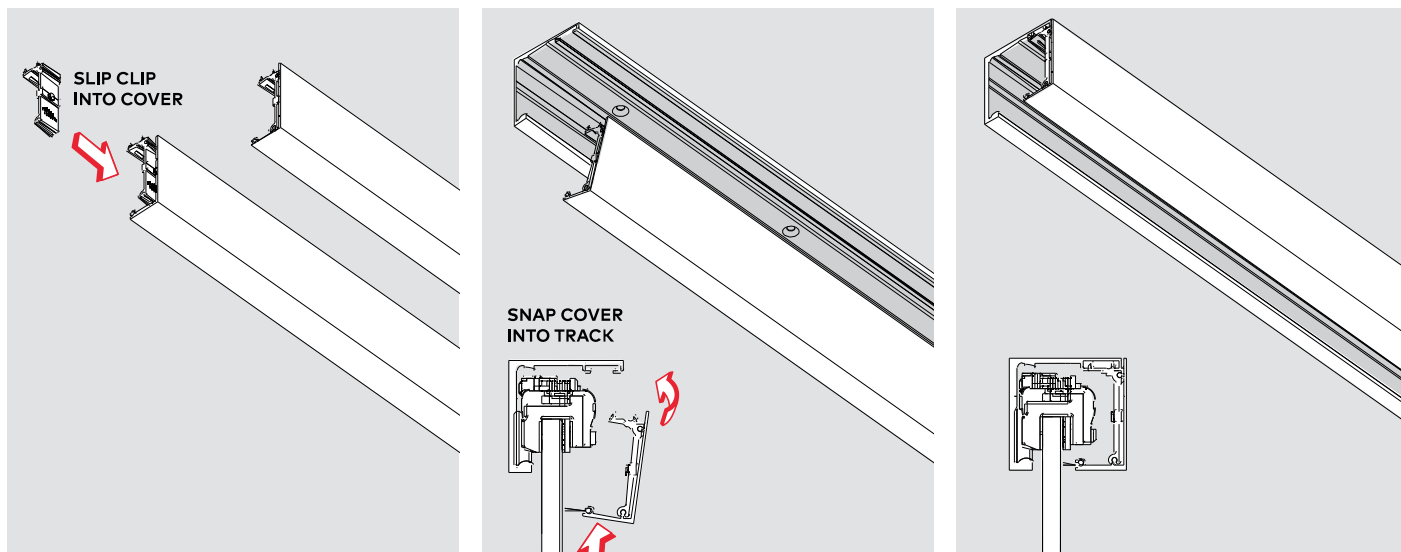

Anti-jump device

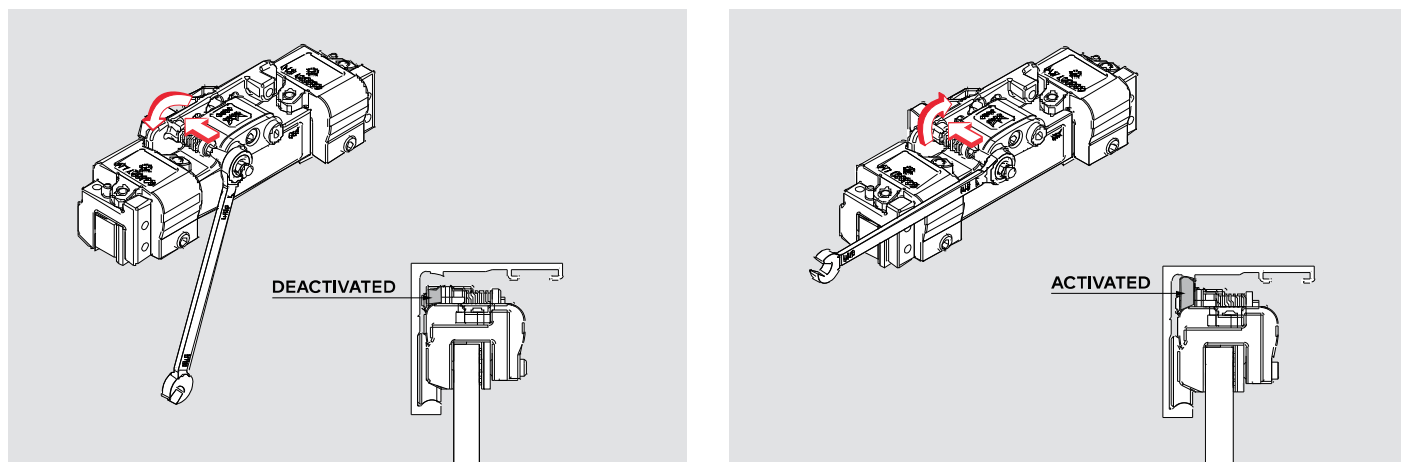

Height adjustment

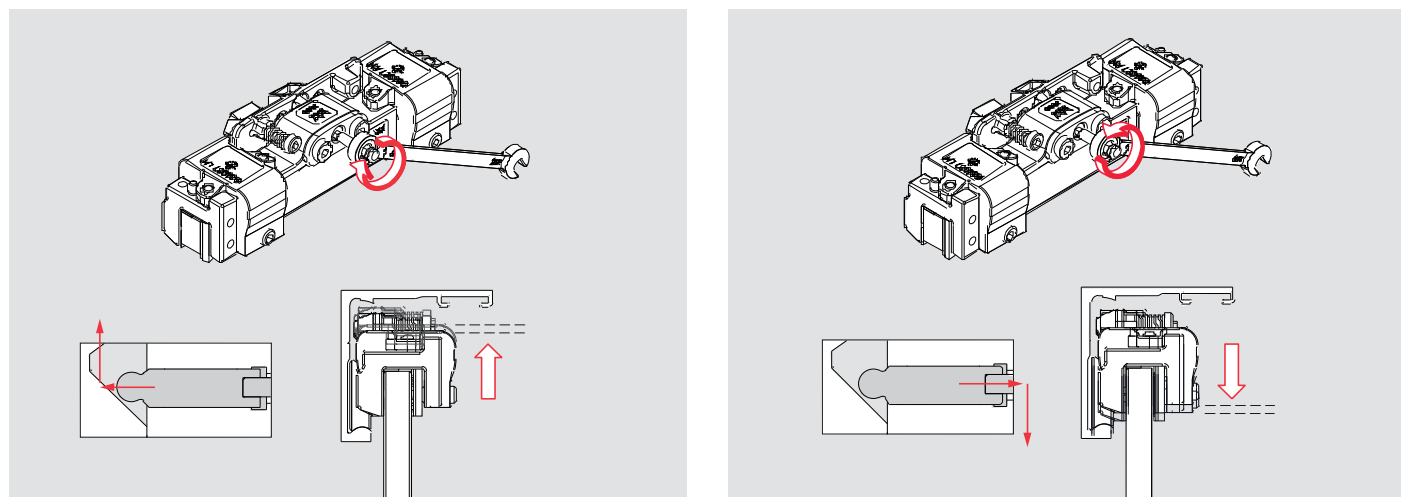

Installation made easy

Retrofit DORMOTION in the field
(minimum door panel widths must be considered)

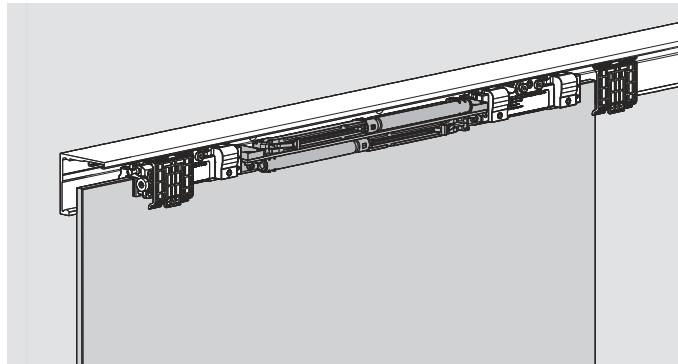
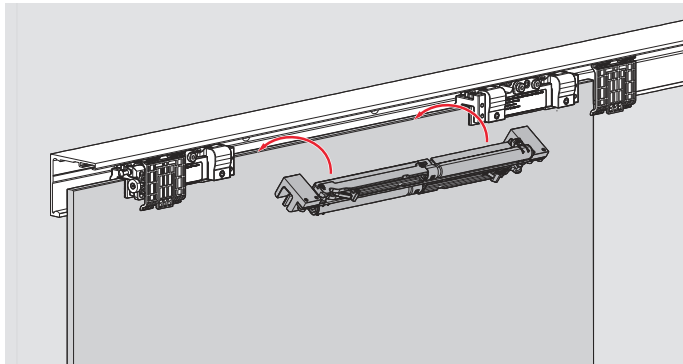

Optional status indicator
retrofitted in field

Adjustable endstop

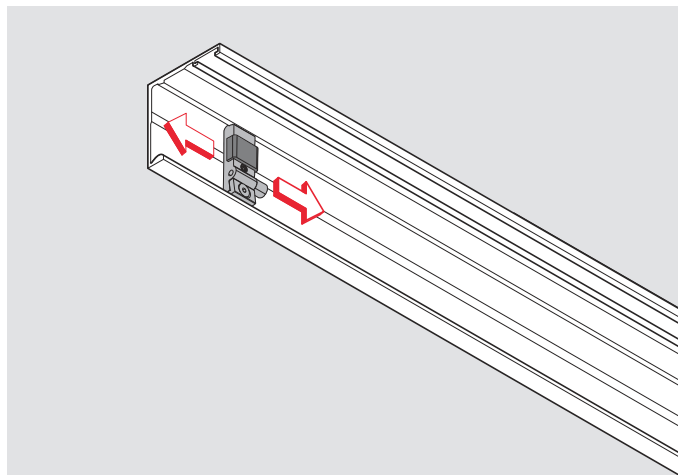
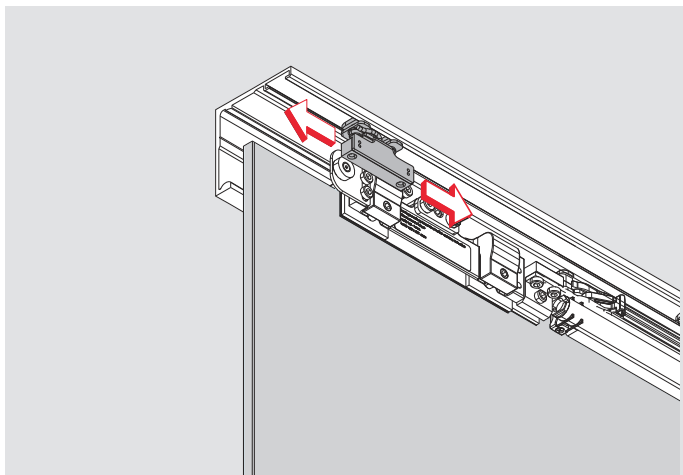

TLG compatibility

dormakaba's Clamp & Glue technology allows installation to tempered laminated glass. This technology allows secure holding power with minimal clamping force, and does not require special glass preparation.

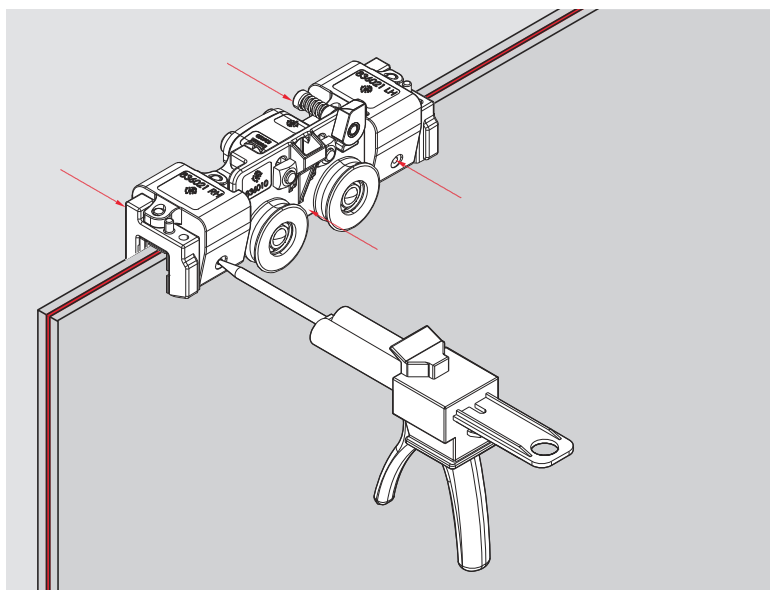

Premium XL 150 DM / XL 150 / XL 80 DM

Typical assemblies mounted to wall

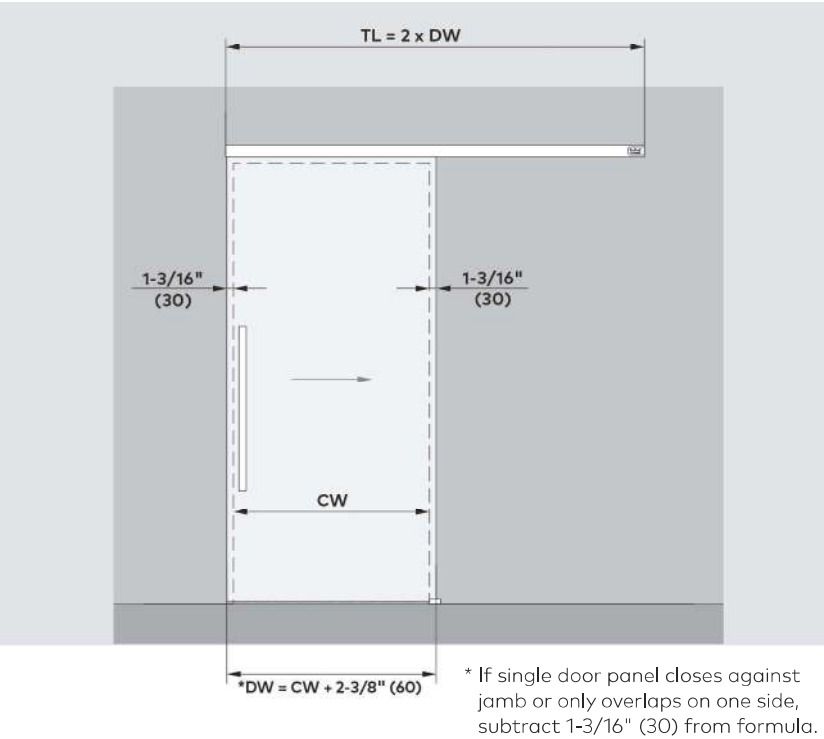

Mounted to wall (W)

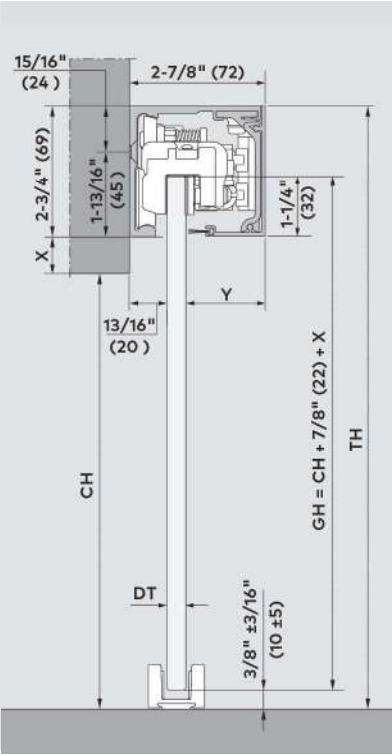

Features and data

For installation with one or two sliding door panels mounted to wall; for 5/16"–9/16" (8 –13.5) thick glass

Max. weight of door panels

330 lb (150 kg) for Premium XL 150 DM/XL 150

176 lb (80 kg) for Premium XL 80 DM

Calculation of glass height

GH = CH + 7/8" (22) + X
(see drawing)
max 118-1/8" (3000)

Calculation of glass width

DW = CW + 2-3/8" (60)

- DW = Glass width
- TL = Track length
- GH = Glass height
- TH = Total height
- CH = Clear opening height
- CW = Clear opening width
- DT = Door (glass) thickness
- Y = 2-7/8" (72) – 13/16" (20) – DT
- X = Bottom of track channel to top of clear opening

	XL 150 DM	XL 150	XL 80 DM
min DW	40-3/16" (1020)	26" (660)	31-7/8" (810)
max DW	57" (1448)	57" (1448)	57" (1448)
max 2P DW	2 x 57" (1448)	2 x 57" (1448)	2 x 57" (1448)

Premium XL 150 DM / XL 150 / XL 80 DM

Typical assemblies mounted to ceiling

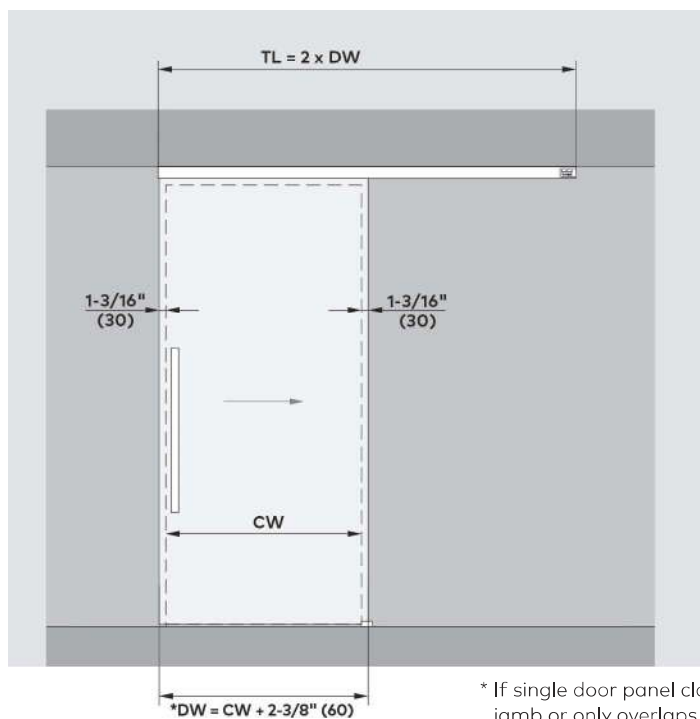

* If single door panel closes against jamb or only overlaps on one side, subtract 1-3/16" (30) from formula.

Features and data

For installation with one or two sliding door panels mounted to ceiling; for 5/16"–9/16" (8 –13.5) thick glass

Max. weight of door panels

330 lb (150 kg) for
Premium XL 150 DM/XL 150

176 lb (80 kg) for
Premium XL 80 DM

Calculation of glass height (CE-S)

$$GH = TH - 1-7/8" (47)$$

max 118-1/8" (3000)

Calculation of glass width

$$DW = CW + 2-3/8" (60)$$

Mounted to ceiling (CE-S)

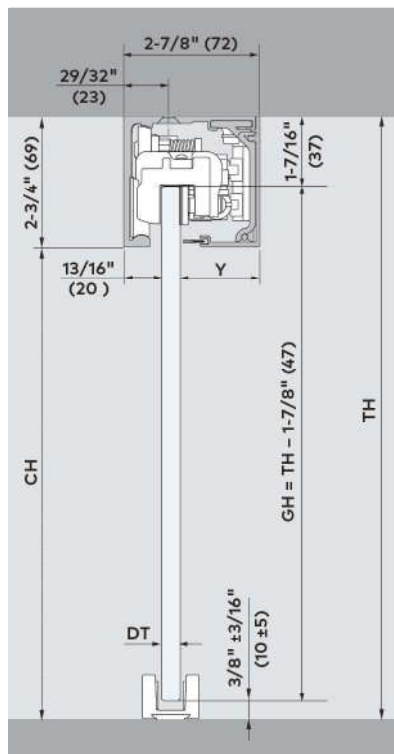

XL 150 DM	
min DW	40-3/16" (1020)
max DW	57" (1448)
max 2P DW	2 × 57" (1448)
XL 150	
min DW	26" (660)
max DW	57" (1448)
max 2P DW	2 × 57" (1448)
XL 80 DM	
min DW	31-7/8" (810)
max DW	57" (1448)
max 2P DW	2 × 57" (1448)

DW = Glass width
TL = Track length
GH = Glass height
TH = Total height
CH = Clear opening height
CW = Clear opening width
DT = Door (glass) thickness
Y = 2-7/8" (72) – 13/16" (20) – DT

Premium XL 150 DM / XL 150 / XL 80 DM

Typical assemblies mounted to or in ceiling with one sliding panel and fixed panel on one side

Features and data

For installation with one sliding door panel with fixed panel, mounted to ceiling or in ceiling; for 5/16"–9/16" (8–13.5) thick glass

Max. weight of door panels

330 lb (150 kg) for
Premium XL 150 DM/XL 150

176 lb (80 kg) for
Premium XL 80 DM

Calculation of glass width

$DW = CW + 1\text{-}3/16"$ (30)

	XL 150 DM
min DW	40-3/16" (1020)
max DW	57" (1448)
	XL 150
min DW	26" (660)
max DW	57" (1448)
	XL 80 DM
min DW	31-7/8" (810)
max DW	57" (1448)

Calculation of glass height (CE-S/CE-R)

$GH = TH - 1\text{-}7/8"$ (47)

$FPH = CH + 1/8"$ (3)

max 118-1/8" (3000)

DW = Glass width
TL = Track length
GH = Glass height sliding door
FPH = Fixed panel (sidelite) height
TH = Total height
CH = Clear opening height
CW = Clear opening width
FPW = Fixed panel (sidelite) width
DT = Door (glass) thickness
FPT = Fixed panel (glass) thickness
Y = $2\text{-}7/8"$ (72) – $13/16"$ (20) – DT

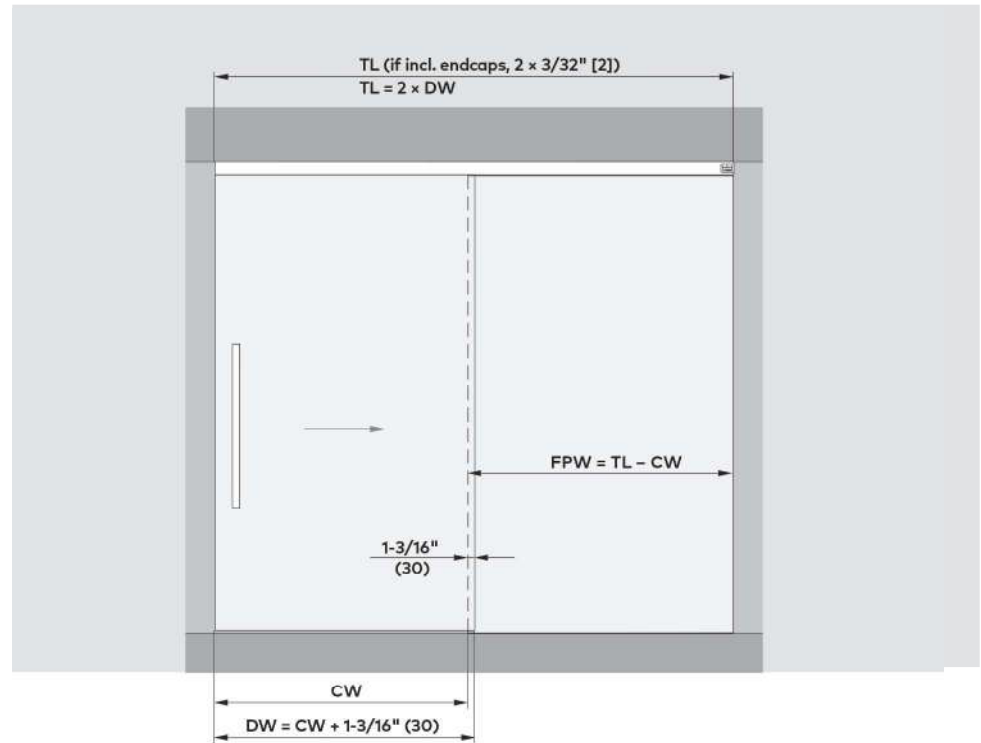

Mounted to ceiling (CE-S)

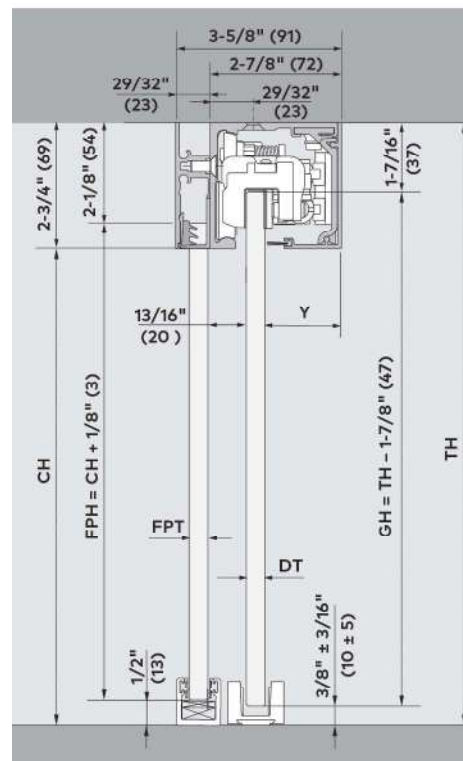

Mounted in ceiling (CE-R)

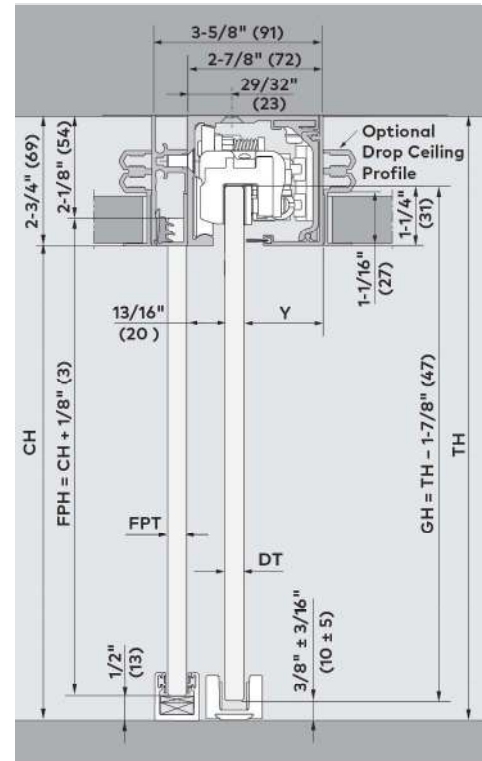

Premium XL 150 DM / XL 150 / XL 80 DM

Typical assemblies mounted to or in ceiling with one sliding panel and fixed panels on both sides

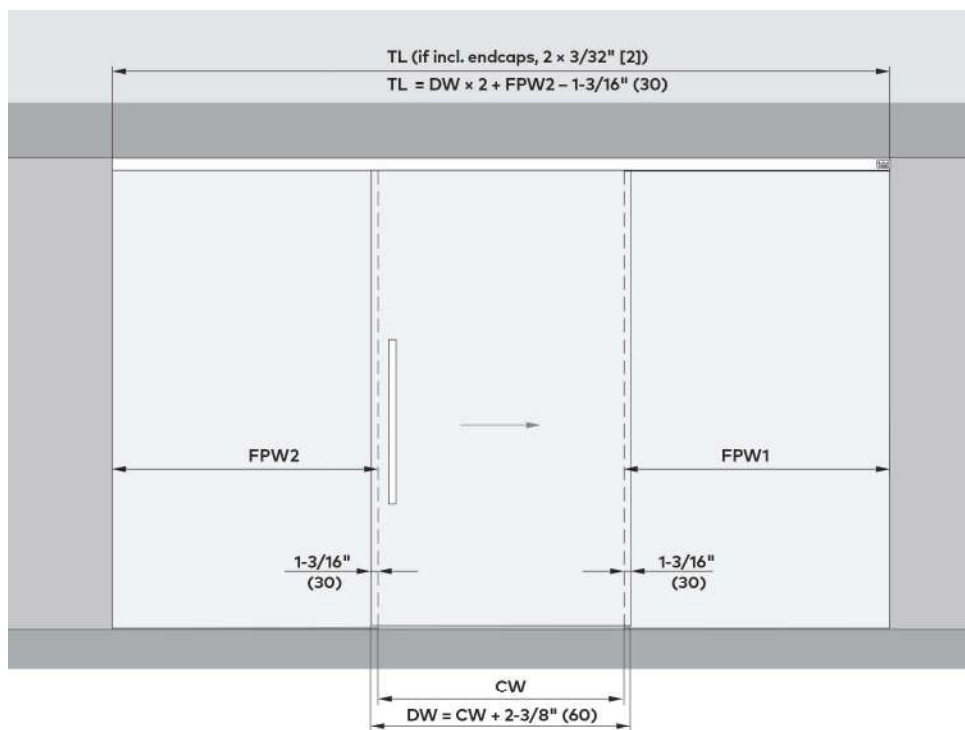

Features and data

For installation with one sliding door panel with fixed panel on both sides; for 5/16"–9/16" (8–13.5) thick glass

Max. weight of door panels

330 lb (150 kg) for
Premium XL 150 DM/XL 150

176 lb (80 kg) for
Premium XL 80 DM

Calculation of glass width

$DW = CW + 2\text{-}3/8"$ (60)

XL 150 DM

min DW 40-3/16" (1020)

max DW 57" (1448)

XL 150

min DW 26" (660)

max DW 57" (1448)

XL 80 DM

min DW 31-7/8" (810)

max DW 57" (1448)

Mounted to ceiling (CE-S)

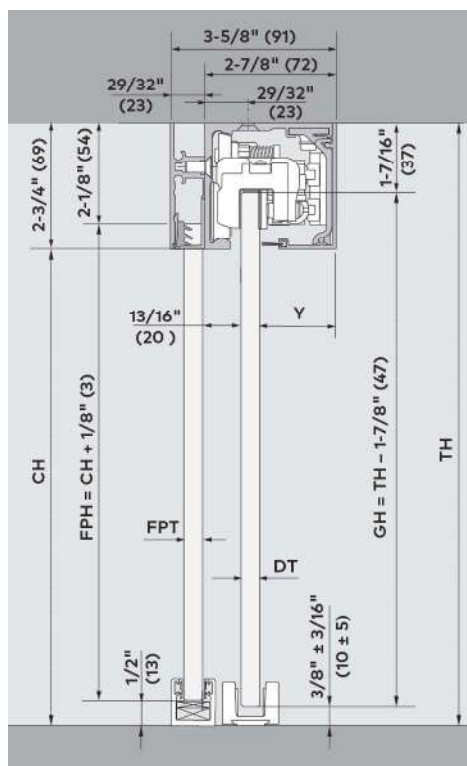

Mounted in ceiling (CE-R)

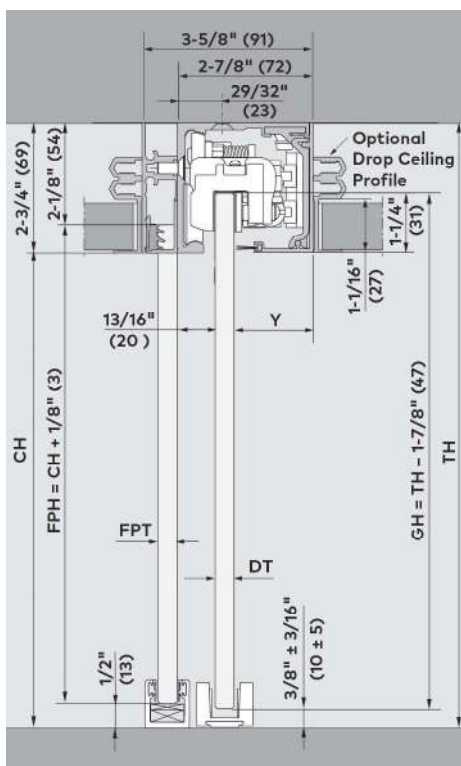

Calculation of glass height (CE-S/CE-R)

$GH = TH - 1\text{-}7/8"$ (47)

$FPH = CH + 1/8"$ (3)

max 118-1/8" (3000)

- DW = Glass width
- TL = Track length
- GH = Glass height sliding door
- FPH = Fixed panel (sidelite) height
- TH = Total height
- CH = Clear opening height
- CW = Clear opening width
- FPW1 = Fixed panel (sidelite) width 1
- FPW2 = Fixed panel (sidelite) width 2
- DT = Door (glass) thickness
- FPT = Fixed panel (glass) thickness
- Y = $2\text{-}7/8"$ (72) – $13/16"$ (20) – DT

Premium XL 150 DM / XL 150 / XL 80 DM

Typical assemblies mounted to or in ceiling with one sliding panel and fixed panels on both sides

Features and data

For installation with two sliding door panels with fixed panel on each side mounted to ceiling or in ceiling; for 5/16"-9/16" (8-13.5) thick glass

Max. weight of door panels

330 lb (150 kg) for
Premium XL 150 DM/XL 150

176 lb (80 kg) for
Premium XL 80 DM

Calculation of glass width

$DW = CW \div 2 + 1-1/16"$ (27)

	XL 150 DM
min 2P DW	2 × 40-3/16" (1020)
max 2P DW	2 × 57" (1448)
	XL 150
min 2P DW	2 × 26" (660)
max 2P DW	2 × 57" (1448)
	XL 80 DM
min 2P DW	2 × 31-7/8" (810)
max 2P DW	2 × 57" (1448)

DW	=	Glass width
TL	=	Track length
GH	=	Glass height sliding door
FPH	=	Fixed panel (sidelite) height
TH	=	Total height
CH	=	Clear opening height
CW	=	Clear opening width
FPW1	=	Fixed panel (sidelite) width 1
FPW2	=	Fixed panel (sidelite) width 2
DT	=	Door (glass) thickness
FPT	=	Fixed panel (glass) thickness
Y	=	2-7/8" (72) – 13/16" (20) – DT

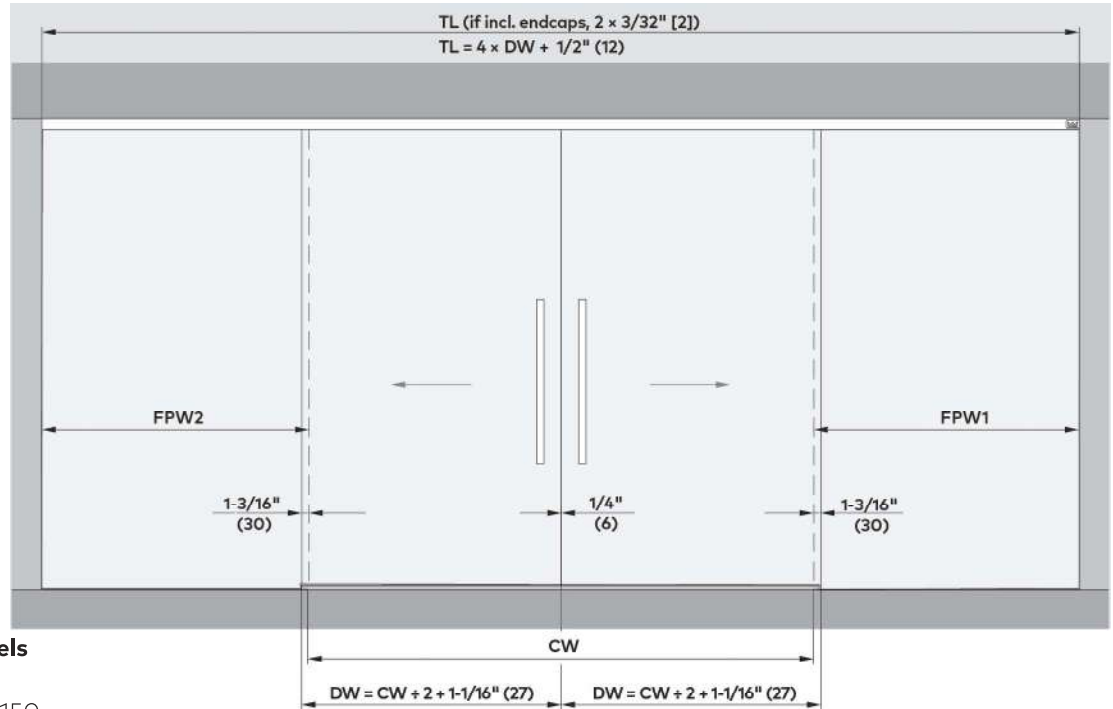

Mounted to ceiling (CE-S)

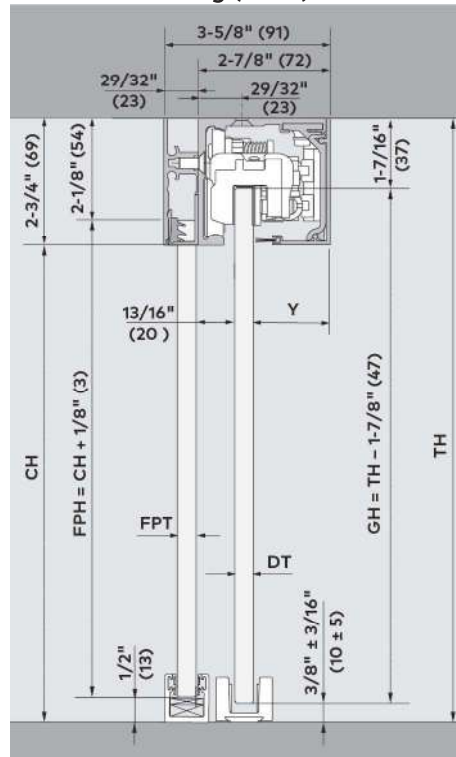

Mounted in ceiling (CE-R)

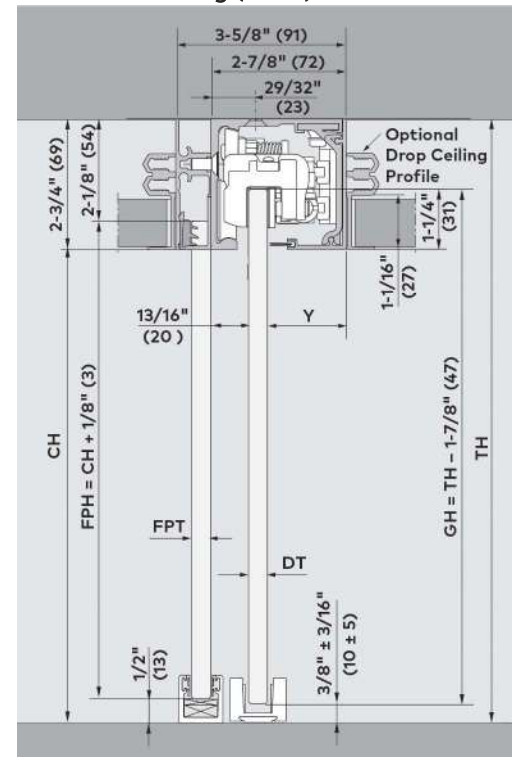

Calculation of glass height (CE-S/CE-R)

$GH = TH - 1-7/8"$ (47)

$FPH = CH + 1/8"$ (3)

max 118-1/8" (3000)

Premium XL 150 DM / XL 150 / XL 80 DM

Typical assemblies for wood doors

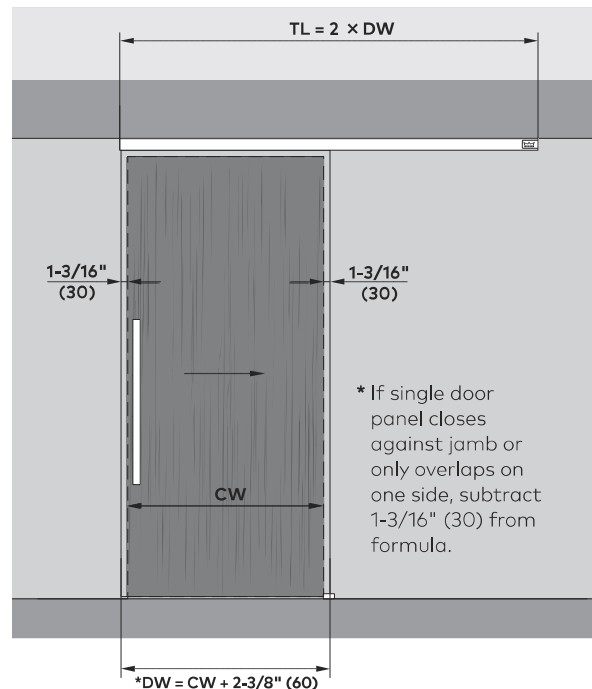
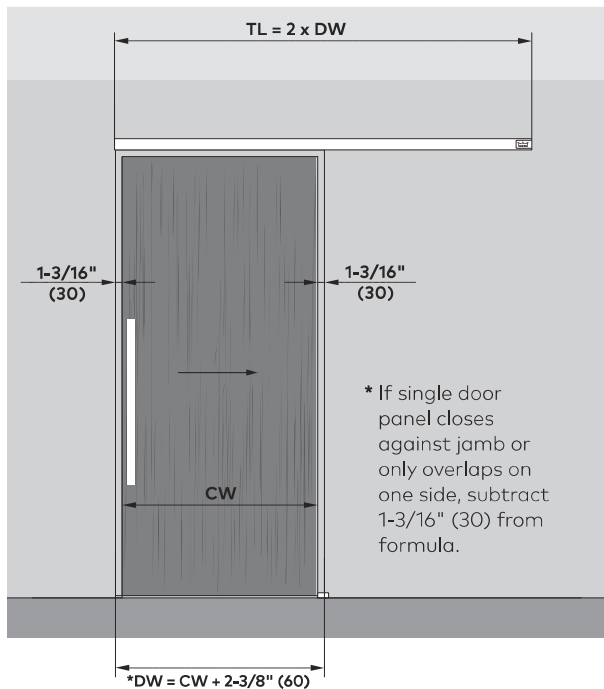

Mounted to wall (W)

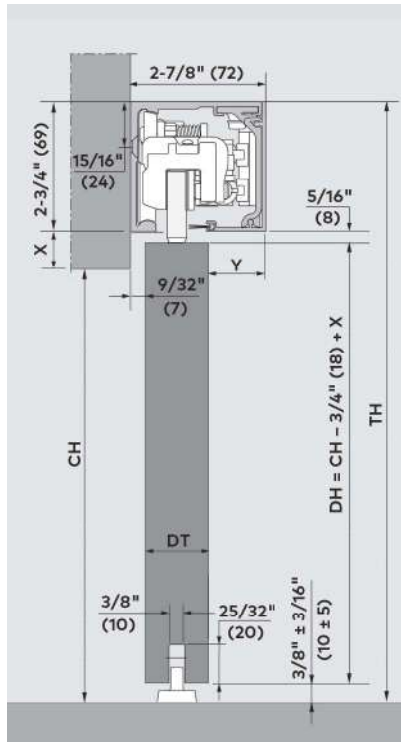

Mounted to or in ceiling (CE-S/CE-R)

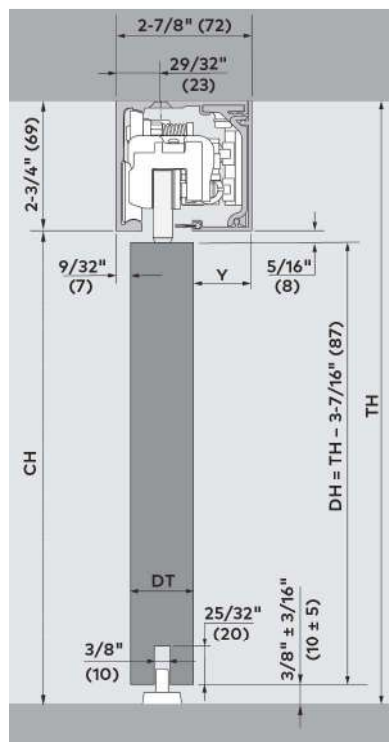

Features and data

For installation with wood door; mounted to wall or ceiling; for 1-1/8" – 1-31/32" (28 – 50) thick wood doors

Max. weight of door panels

330 lb (150 kg) for Premium XL 150 DM/XL 150

176 lb (80 kg) for Premium XL 80 DM

Calculation of door height

$DH = CH - 3/4" (18) + X$ (wall)

$DH = TH - 3\text{-}7/16" (87)$ (ceiling)

max 118-1/8" (3000)

Calculation of door width

$DW = CW + 2\text{-}3/8" (60)$

DW = Glass width
TL = Track length
TH = Total height
DH = Door height
DT = Door (wood) thickness
CH = Clear opening height
CW = Clear opening width
Y = 2-7/8" (72) – 5/16" (7) – DT
X = Bottom of track channel to top of clear opening

	XL 150 DM	XL 150	XL 80 DM
min DW	40-3/16" (1020)	26" (660)	31-7/8" (810)
max DW	60" (1524)	60" (1524)	60" (1524)
max 2P DW	2 × 60" (1524)	2 × 60" (1524)	2 × 60" (1524)

Premium XL 150 DM / XL 80 DM

Typical assemblies mounted on glass with two sliding panels

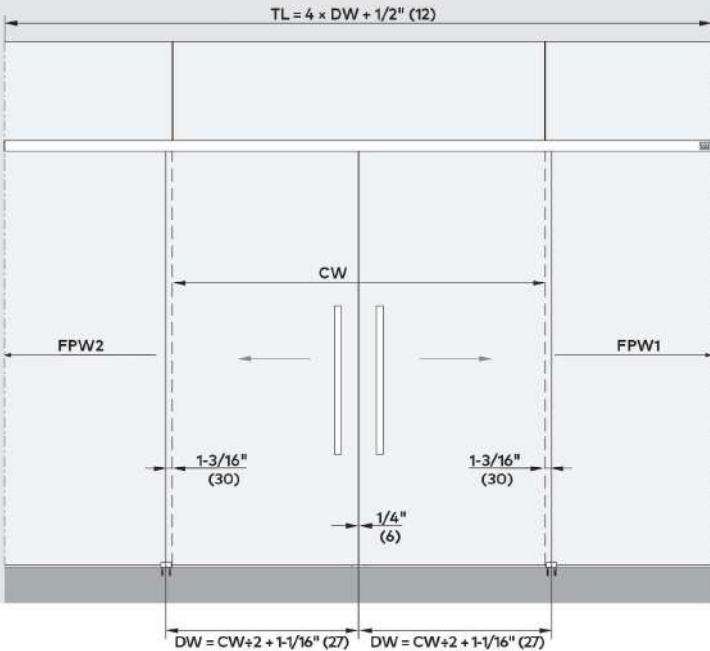

Refer to Elevation drawing on previous page.

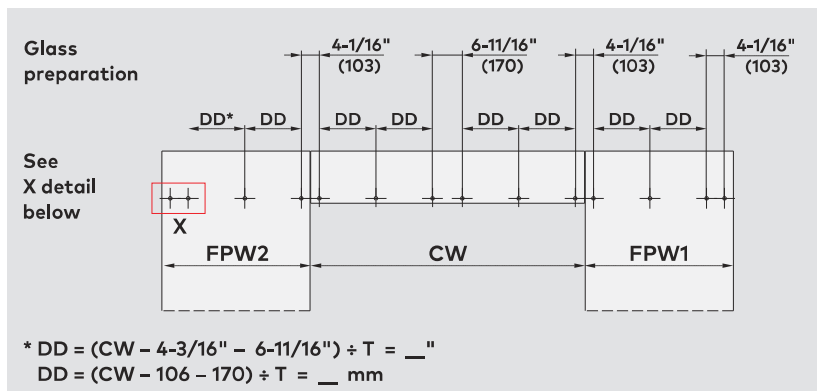

- DW** = Glass width
Z = Quantity of drillings
TL = Track length
DD = Drilling distance
TH = Total height
CH = Clear opening height
CW = Clear opening width
GH = Door (glass) height
FPW = Fixed panel (glass) width
T = Set formula value derived from CW
DT = Door (glass) thickness
 3/8" - 3/4" (10 - 19)
FPT = Fixed panel (sidelite) thickness
Y = 2-7/8" (72) - 13/16" (20) - DT

X detail

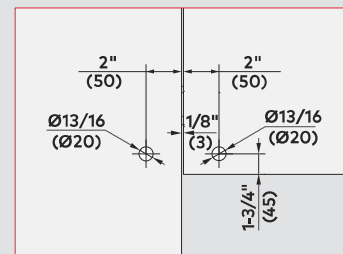

Features and data

For installation with two sliding panels mounted on glass; for 5/16"-9/16" (8 -13.5) thick glass

Max. weight of door panels

330 lb (150 kg) for
Premium XL 150 DM

176 lb (80 kg) for
Premium XL 80 DM

Calculation of glass height

GH = CH + 7/8" (22)

max 118-1/8" (3000)

Calculation of glass width

DW = CW ÷ 2 + 1-1/16" (27)

	XL 150 DM	XL 80 DM
min DW	40-3/16" (1020)	31-7/8"
min CW	78-3/16" (1986)	61-11/16"
max DW	57" (1448)	57"
max CW	112-1/16" (2846)	112-1/16" (2846)

Calculation example

DD = (55-1/8" - 4-3/16" - 6-11/16") ÷ 4 = 11-1/16"
 DD = (1400 - 106 - 170) ÷ 4 = 281

	T	Z
CW ≥ 47-1/4" (1200)	4	14
≤ 59-1/16" (1500)		
CW > 59-1/16" (1500)	6	18
≤ 78-3/4" (2000)		
CW > 78-3/4" (2000)	8	22
≤ 112-1/16" (2846)		

T = Formula Value

Z = Quantity of holes
to drill

The total quantity of holes (Z) depends on clear opening width (CW) and determines the final drilling distance (DD).

- Use the equation to determine (DD) drilling distance (hole spacing) at defined (DD) locations.
- Provide (CW) clear opening width to determine value for (T).
- Insert value for (T) to formula equation to calculate (DD) drilling distance.

Premium XL 150 DM / XL 150 / XL 80 DM

Sliding door sets with one sliding panel and one or two fixed panels, ceiling surface installation

Incl. track/endcaps, cover, cover clips, gasket, end stops, roller carriers, DORMOTION¹, DM start/stops¹, floor guide, sidelite profile and gasket, sidelite filler profile, sidelite endcaps, U-Channel and gasket, and sidelite mounting hardware. (Sidelite view profile included if appropriate.)

Complete accessories for 5/16"–9/16" (8–13.5) thick glass.

XL 150 DM / XL 150 max 330 lb (150 kg).

XL 80 DM max 176 lb (80 kg).

¹ XL 150 set does not include DORMOTION or DM start/stops.

1P ceiling surface by 1FP – Set for ceiling surface installation with one sliding panel and one fixed panel.

	Min panel width	Min clear opening width	Max panel width ²	Max clear opening width ²	Max track length ²	Ref. No.
1P XL 150 DM CE-S 1FP						
MTO	40-3/16" (1020)	37-13/16" (960)	57" (1448)	54-5/8" (1388)	157-1/2" (4000)	236.589
1P XL 150 CE-S 1FP						
MTO	26" (660)	23-5/8" (600)	57" (1448)	54-5/8" (1388)	157-1/2" (4000)	236.588
1P XL 80 DM CE-S 1FP						
MTO	31-7/8" (810)	29-1/2" (750)	57" (1448)	54-5/8" (1388)	157-1/2" (4000)	236.583

1P ceiling surface by 2FP – Set for ceiling surface installation with one sliding panel and two fixed panels.

	Min panel width	Min clear opening width	Max panel width ²	Max clear opening width ²	Max track length ²	Ref. No.
1P XL 150 DM CE-S 2FP						
MTO	40-3/16" (1020)	37-13/16" (960)	57" (1448)	54-5/8" (1388)	157-1/2" (4000)	236.591
1P XL 150 CE-S 2FP						
MTO	26" (660)	23-5/8" (600)	57" (1448)	54-3/8" (1381)	157-1/2" (4000)	236.590
1P XL 80 DM CE-S 2FP						
MTO	31-7/8" (810)	29-1/2" (750)	57" (1448)	54-3/8" (1381)	157-1/2" (4000)	236.585

2P ceiling surface by 2FP – Set for ceiling surface installation with two sliding panels and two fixed panels.

	Min panel width	Min clear opening width	Max panel width ²	Max clear opening width ²	Max track length ²	Ref. No.
2P XL 150 DM CE-S 2FP						
MTO	40-3/16" (1020)	78-3/16" (1986)	57" (1448)	111-7/8" (2842)	157-1/2" (4000)	236.587
2P XL 150 CE-S 2FP						
MTO	26" (660)	49-13/16" (1266)	57" (1448)	111-7/8" (2842)	157-1/2" (4000)	236.592
2P XL 80 DM CE-S 2FP						
MTO	31-7/8" (810)	59-1/4" (1505)	57" (1448)	111-7/8" (2842)	157-1/2" (4000)	236.587

² For 157-1/2" track lengths, only 154" are useable.

Max wood door sizes can be increased by 3" (76), MTO only.

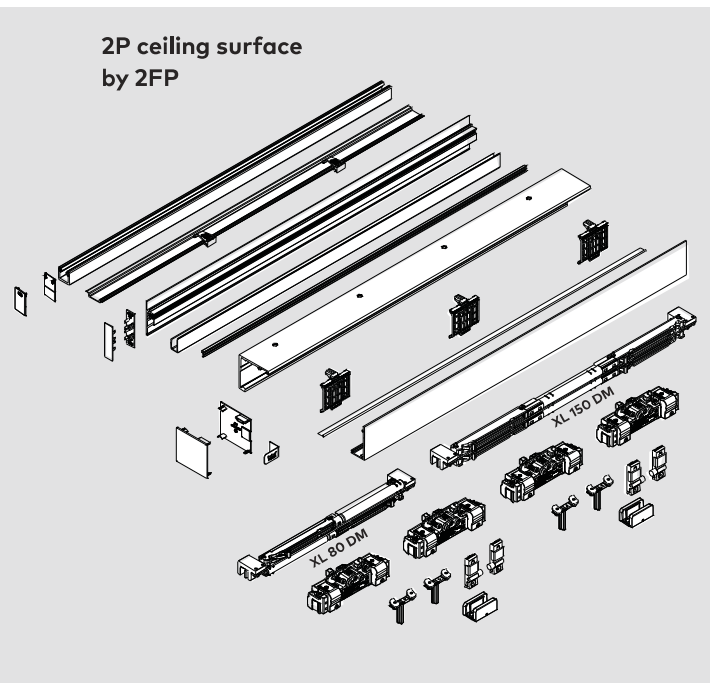
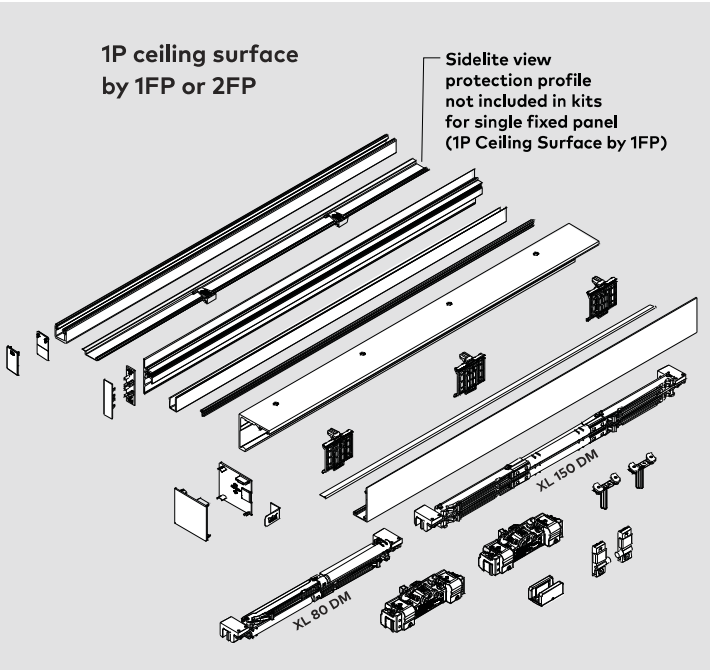

Note: Refer to Component parts section for wood door adapter options.

Premium XL 150 DM / XL 150 / XL 80 DM

Sliding door sets with one sliding panel and one or two fixed panels, ceiling recessed installation

Incl. track/endcaps, cover, cover clips, gasket, end stops, roller carriers, DORMOTION¹, DM start/stops¹, floor guide, sidelite profile and gasket, sidelite filler profile, sidelite endcaps, U-Channel and gasket, and sidelite mounting hardware. (Sidelite view profile included if appropriate.)

Complete accessories for 5/16"–9/16" (8–13.5) thick glass.

XL 150 DM / XL 150 max 330 lb (150 kg).

XL 80 DM max 176 lb (80 kg).

¹XL 150 set does not include DORMOTION or DM start/stops.

1P ceiling recessed by 1FP – Set for ceiling recessed installation with one sliding panel and one fixed panel.

	Min panel width	Min clear opening width	Max panel width ²	Max clear opening width ²	Max track length ²	Ref. No.
1P XL 150 DM CE-R 1FP						
MTO	40-3/16" (1020)	37-13/16" (960)	57" (1448)	54-5/8" (1388)	157-1/2" (4000)	236.595
1P XL 150 CE-R 1FP						
MTO	26" (660)	23-5/8" (600)	57" (1448)	54-5/8" (1388)	157-1/2" (4000)	236.594
1P XL 80 DM CE-R 1FP						
MTO	31-7/8" (810)	29-1/2" (750)	57" (1448)	54-5/8" (1388)	157-1/2" (4000)	236.582

1P ceiling recessed by 2FP – Set for ceiling recessed installation with one sliding panel and two fixed panels.

	Min panel width	Min clear opening width	Max panel width ²	Max clear opening width ²	Max track length ²	Ref. No.
1P XL 150 DM CE-R 2FP						
MTO	40-3/16" (1020)	37-13/16" (960)	57" (1448)	54-5/8" (1388)	157-1/2" (4000)	236.597
1P XL 150 CE-R 2FP						
MTO	26" (660)	23-5/8" (600)	57" (1448)	54-3/8" (1381)	157-1/2" (4000)	236.596
1P XL 80 DM CE-R 2FP						
MTO	31-7/8" (810)	29-1/2" (750)	57" (1448)	54-3/8" (1381)	157-1/2" (4000)	236.584

2P ceiling recessed by 2FP – Set for ceiling recessed installation with two sliding panels and two fixed panels.

	Min panel width	Min clear opening width	Max panel width ²	Max clear opening width ²	Max track length ²	Ref. No.
2P XL 150 DM CE-R 2FP						
MTO	40-3/16" (1020)	78-3/16" (1986)	57" (1448)	111-7/8" (2842)	157-1/2" (4000)	236.599
2P XL 150 CE-R 2FP						
MTO	26" (660)	49-13/16" (1266)	57" (1448)	111-7/8" (2842)	157-1/2" (4000)	236.598
2P XL 80 DM CE-R 2FP						
MTO	31-7/8" (810)	59-1/4" (1505)	57" (1448)	111-7/8" (2842)	157-1/2" (4000)	236.586

² For 157-1/2" track lengths, only 154" are useable.

Max wood door sizes can be increased by 3" (76), MTO only.

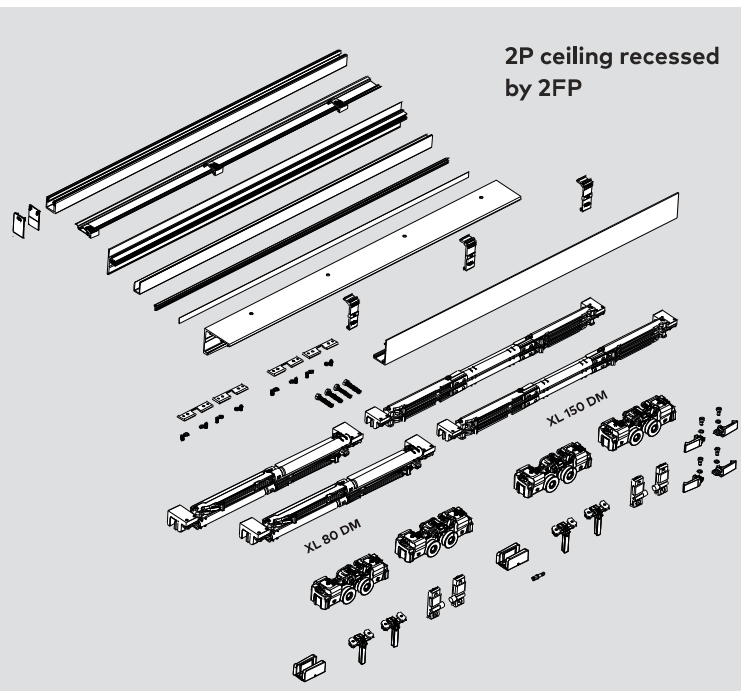
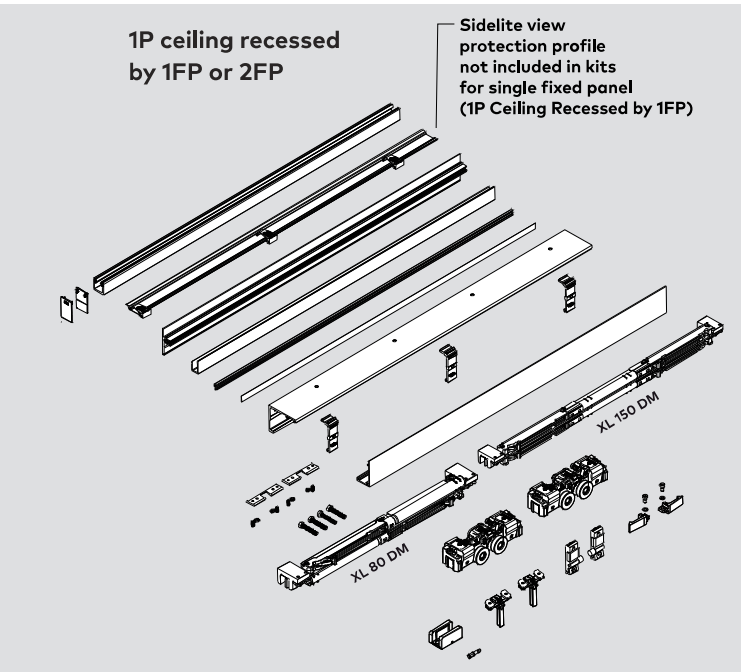

Note: Refer to Component parts section for wood door adapter options.

Premium XL 150 DM / XL 150 / XL 80 DM

Sliding door sets with one sliding panel

Incl. track/endcaps, cover, cover clips, gasket, end stops, roller carriers, DORMOTION¹, DM start/stops¹, and floor guide.
Complete accessories for 5/16"–9/16" (8 –13.5) thick glass.

XL 150 DM / XL 150 max 330 lb (150 kg).

XL 80 DM max 176 lb (80 kg).

¹XL 150 set does not include DORMOTION or DM start/stops.

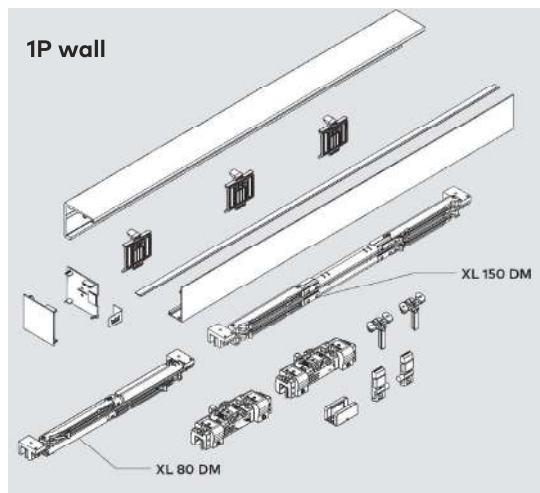

1P wall installation – Set for wall installation with one sliding panel.

	Min panel width	Min clear opening width	Max panel width ²	Max clear opening width ²	Max track length ²	Ref. No.
1P XL 150 DM W						
STK	40-3/16" (1020)	37-13/16" (960)	56-11/16" (1440)	54-5/16" (1380)	113-3/8" (2880)	836.510
MTO	40-3/16" (1020)	37-13/16" (960)	57" (1448)	54-5/8" (1388)	157-1/2" (4000)	836.521
1P XL 150 W						
STK	26" (660)	23-5/8" (600)	56-11/16" (1440)	54-5/16" (1380)	113-3/8" (2880)	236.510
MTO	26" (660)	23-5/8" (600)	57" (1448)	54-5/8" (1388)	157-1/2" (4000)	236.521
1P XL 80 DM W						
STK	31-7/8" (810)	29-1/2" (750)	56-11/16" (1440)	54-5/16" (1380)	113-3/8" (2880)	836.502
MTO	31-7/8" (810)	29-1/2" (750)	57" (1448)	54-5/8" (1388)	157-1/2" (4000)	836.520

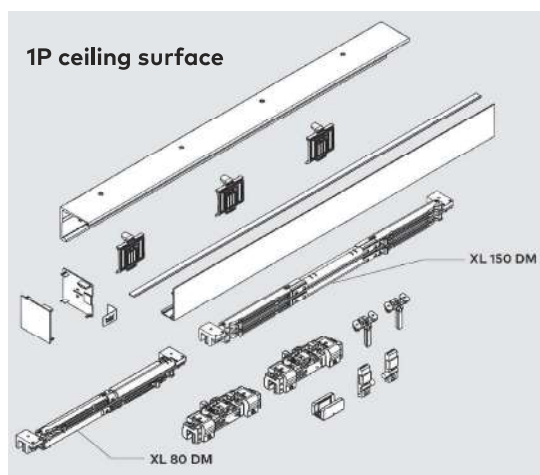

1P ceiling surface installation – Set for ceiling surface installation with one sliding panel.

	Min panel width	Min clear opening width	Max panel width ²	Max clear opening width ²	Max track length ²	Ref. No.
1P XL 150 DM CE-S						
STK	40-3/16" (1020)	37-13/16" (960)	56-11/16" (1440)	54-5/16" (1380)	113-3/8" (2880)	836.512
MTO	40-3/16" (1020)	37-13/16" (960)	57" (1448)	54-5/8" (1388)	157-1/2" (4000)	836.523
1P XL 150 CE-S						
STK	26" (660)	23-5/8" (600)	56-11/16" (1440)	54-5/16" (1380)	113-3/8" (2880)	236.512
MTO	26" (660)	23-5/8" (600)	57" (1448)	54-5/8" (1388)	157-1/2" (4000)	236.523
1P XL 80 DM CE-S						
STK	31-7/8" (810)	29-1/2" (750)	56-11/16" (1440)	54-5/16" (1380)	113-3/8" (2880)	836.505
MTO	31-7/8" (810)	29-1/2" (750)	57" (1448)	54-5/8" (1388)	157-1/2" (4000)	836.522

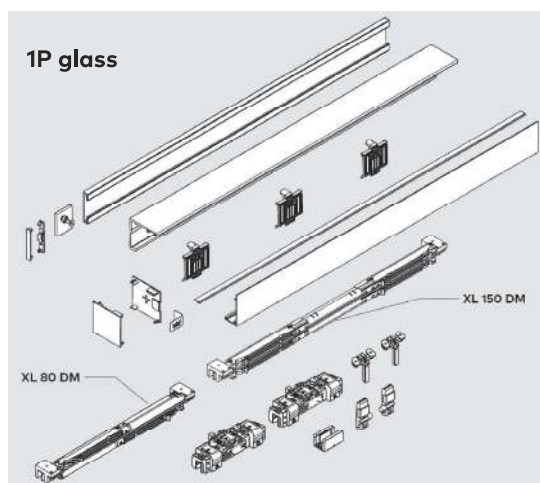

1P glass installation – Set for glass installation with one sliding panel.

	Min panel width	Min clear opening width	Max panel width ²	Max clear opening width ²	Max track length ²	Ref. No.
1P XL 150 DM G						
MTO	40-3/16" (1020)	37-13/16" (960)	57" (1448)	54-5/8" (1388)	157-1/2" (4000)	836.525
1P XL 80 DM G						
MTO	31-7/8" (810)	29-1/2" (750)	57" (1448)	54-5/8" (1388)	157-1/2" (4000)	836.524

Note: Refer to Component parts section for wood door adapter options.

² For 157-1/2" track lengths, only 154" are useable.
Max wood door sizes can be increased by 3" (76), MTO only.

Premium XL 150 DM / XL 150 / XL 80 DM

Sliding door sets with two sliding panels

Incl. track/endcaps, cover, cover clips, gasket, end stops, roller carriers, DORMOTION¹, DM start/stops¹, and floor guide.

Complete accessories for 5/16"–9/16" (8 –13.5) thick glass.

XL 150 DM / XL 150 max 330 lb (150 kg).

XL 80 DM max 176 lb (80 kg).

¹XL 150 set does not include DORMOTION or DM start/stops.

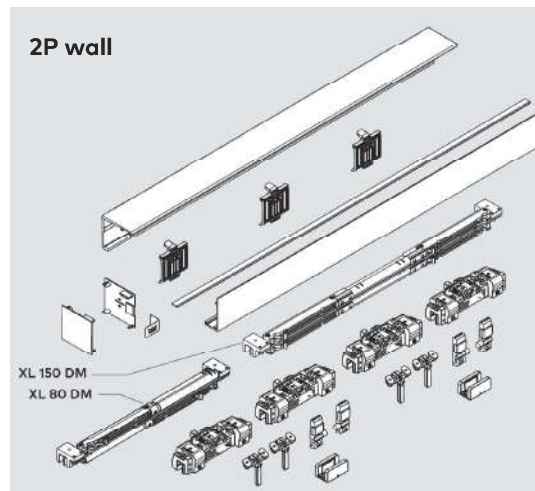

2P wall installation – Set for wall installation with two sliding panels.

	Min panel width	Min clear opening width	Max panel width ²	Max clear opening width ²	Max track length ²	Ref. No.
2P XL 150 DM W						
MTO	40-3/16" (1020)	78-3/16" (1986)	57" (1448)	111-7/8" (2842)	157-1/2" (4000)	836.527
2P XL 150 W						
MTO	26" (660)	49-13/16" (1266)	57" (1448)	111-7/8" (2842)	157-1/2" (4000)	236.527
2P XL 80 DM W						
MTO	31-7/8" (810)	61-5/8" (1566)	57" (1448)	111-7/8" (2842)	157-1/2" (4000)	836.526

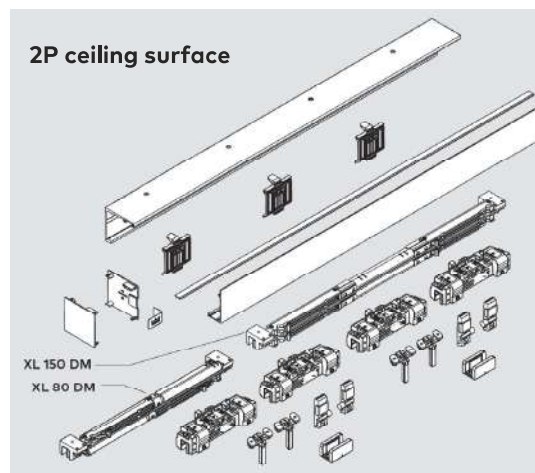

2P ceiling surface installation – Set for ceiling surface installation with two sliding panels.

	Min panel width	Min clear opening width	Max panel width ²	Max clear opening width ²	Max track length ²	Ref. No.
2P XL 150 DM CE-S						
MTO	40-3/16" (1020)	78-3/16" (1986)	57" (1448)	111-7/8" (2842)	157-1/2" (4000)	836.529
2P XL 150 CE-S						
MTO	26" (660)	49-13/16" (1266)	57" (1448)	111-7/8" (2842)	157-1/2" (4000)	236.529
2P XL 80 DM CE-S						
MTO	31-7/8" (810)	61-5/8" (1566)	57" (1448)	111-7/8" (2842)	157-1/2" (4000)	836.528

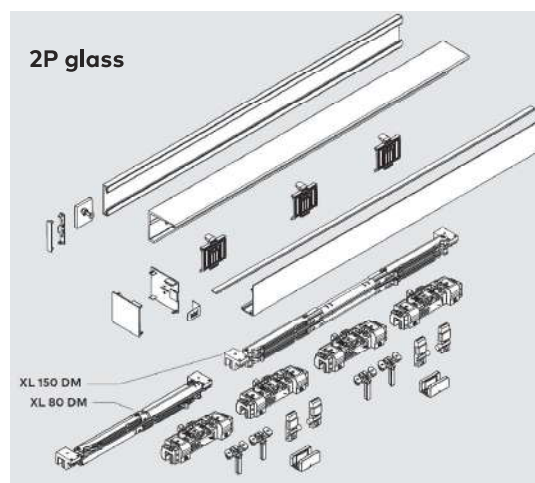

2P glass installation – Set for glass installation with two sliding panels.

	Min panel width	Min clear opening width	Max panel width ²	Max clear opening width ²	Max track length ²	Ref. No.
2P XL 150 DM G						
MTO	40-3/16" (1020)	78-3/16" (1986)	57" (1448)	111-7/8" (2842)	157-1/2" (4000)	836.531
2P XL 80 DM G						
MTO	31-7/8" (810)	61-5/8" (1566)	57" (1448)	111-7/8" (2842)	157-1/2" (4000)	836.530

² For 157-1/2" track lengths, only 154" are useable.
Max wood door sizes can be increased by 3" (76), MTO only.

Note: Refer to Component parts section for wood door adapter options.

Component parts

Roller accessory kit, complete

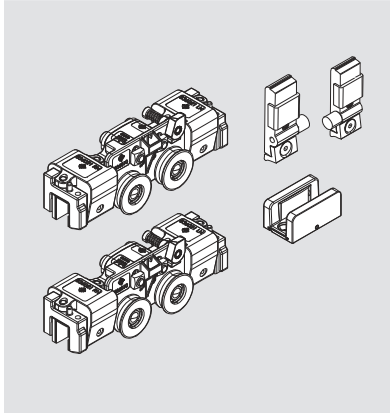

Premium XL 150/120/80 roller carriers

Accessory set for XL 150 DM, XL 150, XL 120 SC, XL 80 DM

Consisting of:
2 clamp carriers,
2 endstops, 1 floor
guide, and non-DM
hooks.

Ref. No. 836.550

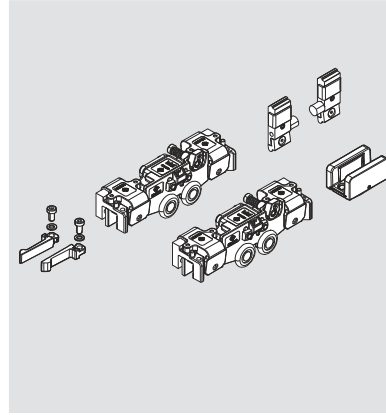

Comfort L 80 roller carriers

Accessory set for use with L 80 DM and L 80.

Consisting of:
2 clamp carriers, 2
endstops, non-DM
hook, and 1 floor guide

Ref. No. 36.349

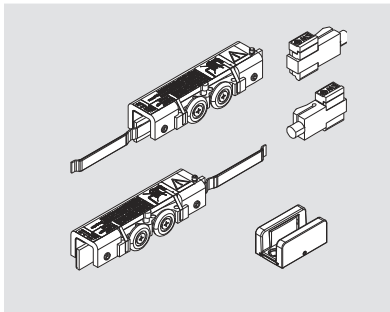

Comfort M 50 accessory set

For use with M 50 or M 50 with optional DM

Consisting of 2 clamp
carriers, 2 endstops, 1
floor guide, and hooks
for non-DM units

Ref. No. 836.150

Gasket sets

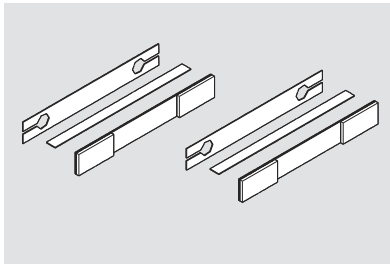

Premium XL 150/120/80 roller gaskets

Gasket set to service
roller carriers for XL 150
DM, XL 150, XL 120 SC,
XL 80 DM

Ref. No. 836.451

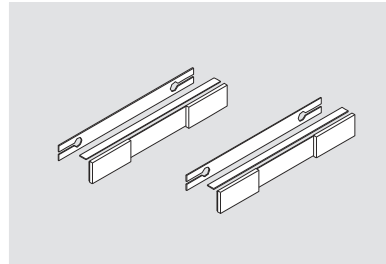

Comfort L 80 roller gasket set

Gasket set to service
roller carriers

Ref. No. 836.251

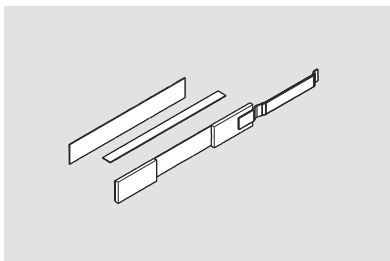

Comfort M 50 roller carrier gasket set

For use with M50 or M
50 with optional DM

Ref. No. 836.151

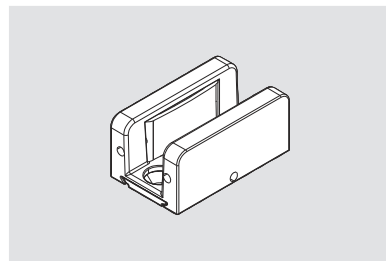

MUTO glass door floor guide

Adjustable
5/16" – 17/32" (8 – 13)

Ref. No. 807.316

Component parts

Track and cover extrusions – XL 150/80 Systems

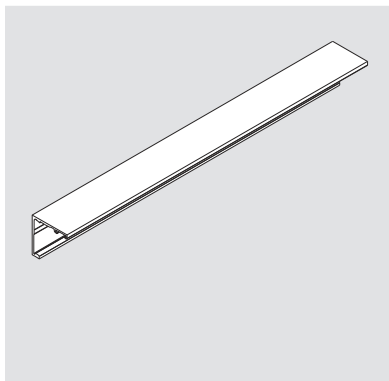

Premium XL 150/80 wall track

Track rail for wall installation for XL 150 DM, XL 150, XL 80 DM

Fixed length
157-1/2" (4000)

Ref. No. 936.552

Specify length (by ft.)

Ref. No. 836.553

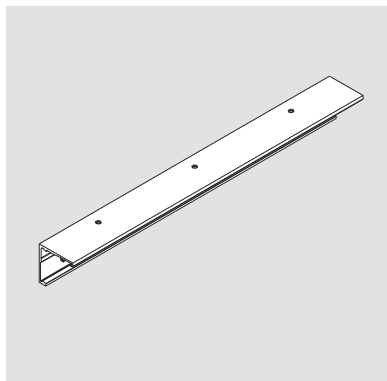

Premium XL 150/80 ceiling fixed panel track

Track rail for ceiling, fixed panel surface mount for XL 150 DM, XL 150, XL 80 DM

Fixed length
157-1/2" (4000)

Ref. No. 936.562

Specify length (by ft.)

Ref. No. 936.563

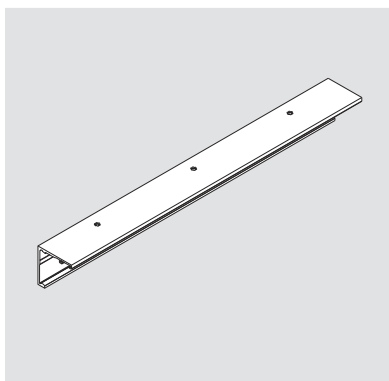

Premium XL 150/80 ceiling track

Track rail for ceiling, surface mount for XL 150 DM, XL 150, XL 80 DM

Fixed length
157-1/2" (4000)

Ref. No. 936.554

Specify length (by ft.)

Ref. No. 836.555

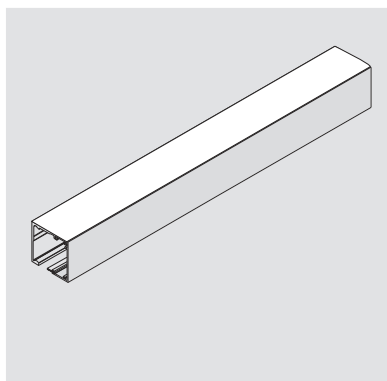

Premium XL 150/80 cover

Cover profile for DORMOTION front cover for XL 150 DM, XL 150, XL 80 DM

Fixed length
157-1/2" (4000)

Ref. No. 936.566

Specify length (by ft.)

Ref. No. 836.567

Component parts

Track and cover extrusions – L 80 Systems

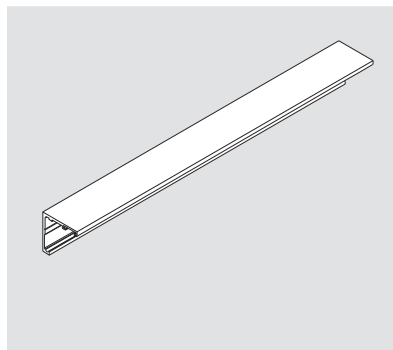

Comfort L 80 wall track

Track rail for L 80 DM and L 80 wall installation

Fixed length
157-1/2" (4000)

Ref. No. 936.350

Specify length (by ft.)
Ref. No. 836.351

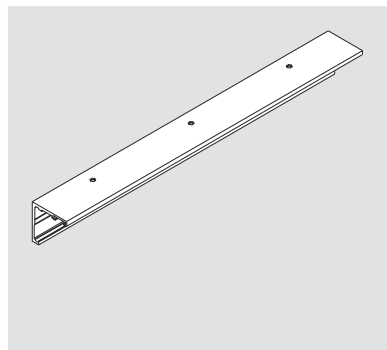

Comfort L 80 ceiling track

Track rail for L 80 DM and L 80 ceiling installation

Fixed length
157-1/2" (4000)

Ref. No. 936.352

Specify length (by ft.)
Ref. No. 836.353

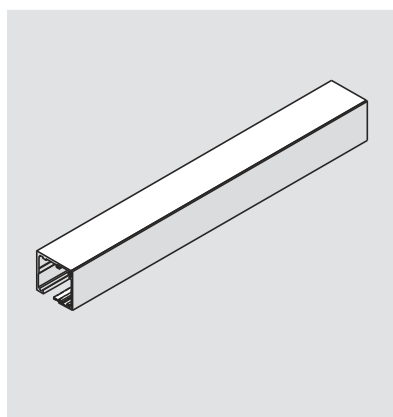

Comfort L 80 cover

Cover profile for L 80 DM and L 80

Fixed length
157-1/2" (4000)

Ref. No. 936.359

Specify length (by ft.)
Ref. No. 836.360

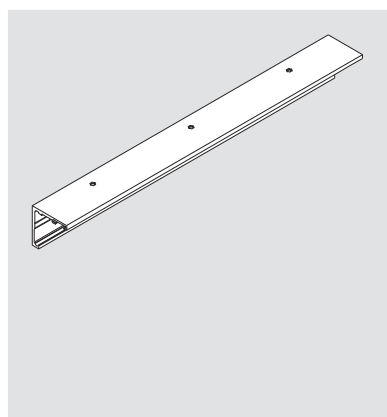

Comfort L 80 ceiling fixed panel track

Track rail for ceiling, fixed panel surface mount for L 80 DM and L 80 ceiling installation

Fixed length
157-1/2" (4000)

Ref. No. 936.361

Specify length (by ft.)
Ref. No. 936.362

Cover clips

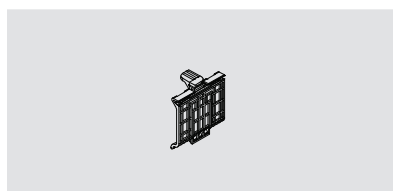

Cover clip for Premium XL systems

Ea.

Ref. No. 836.146

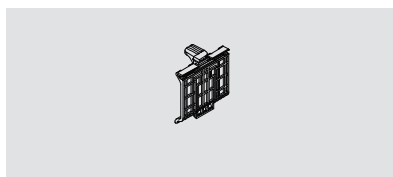

Cover clip for Comfort L and M systems

Ea.

Ref. No. 836.147

Fasteners packs

#12 fasteners and anchors
(5 ea.) for mounting MUTO track profile.

Pk.

Ref. No. 936.995

M6x14 for mounting sidelite profile or drop ceiling profile.

Pk.

Ref. No. 807.585

M6x35 for mounting drop ceiling profile.

Pk.

Ref. No. 836.585

Component parts

Wood adapter sets

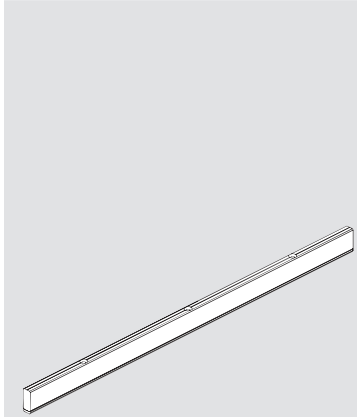

Premium XL 150 wood door kit

Wood door adapter set for use with all XL systems; incl. mounting screws, wood door guide(s), and shim for XL mount

Profile:
 $\frac{1}{2}" \times 1\frac{7}{16}" + \frac{1}{2}" \times \frac{3}{16}"$
 (12.5 x 36 + 12.5 x 4)

Fixed full length
 157-1/2" (4000)

Ref. No. 936.463

Fixed half length
 78-3/4" (2000)

Ref. No. 936.461

Specify length (by ft.)

Ref. No. 936.464

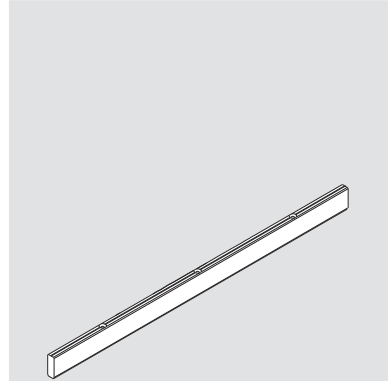

Comfort L 80 wood door kit

Wood door adapter set for L 80 DM and L 80; incl. mounting screws and wood door guide(s)

Profile:
 $\frac{1}{2}" \times 1\frac{7}{16}"$ (12.5 x 36)

Fixed full length
 157-1/2" (4000)

Ref. No. 936.262

Fixed half length
 78-3/4" (2000)

Ref. No. 936.261

Specify length (by ft.)

Ref. No. 936.263

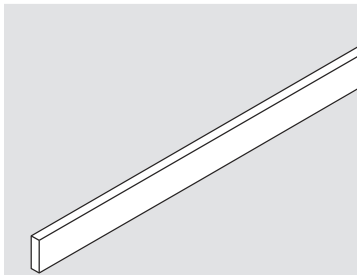

Comfort M 50 wood door kit

Wood door adapter set

Profile:
 $\frac{1}{2}" \times 1\frac{3}{8}"$ (10 x 35)
 incl. mounting screws,
 and wood door floor
 guide

Ref. No. 836.157

Wood door floor guide

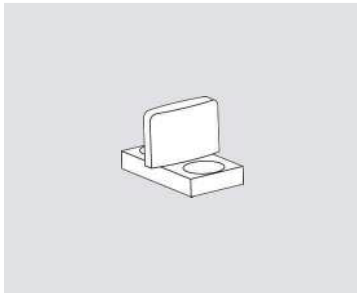

MUTO wood door floor guide

Adjustable
 $\frac{5}{16}" - 17/32"$ (8 - 13)

Ref. No. 836.148

Component parts

Endcaps

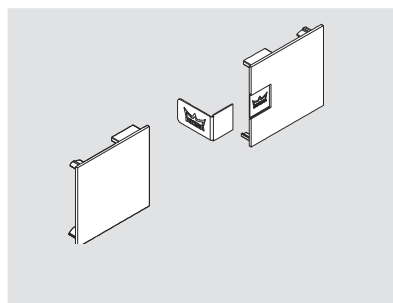

Premium XL 150/80 endcaps

Set endcaps for wall and ceiling installation for XL 150 DM, XL 150, XL 80 DM

Ref. No. 836.556

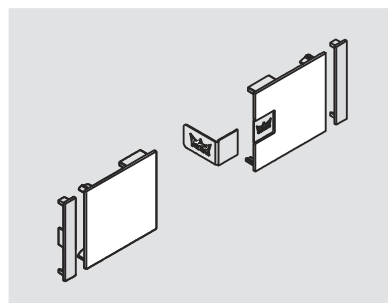

Premium XL 150/80 glass mount endcaps

Set endcaps for installation on glass for XL 150 DM, XL 150, XL 80 DM

Ref. No. 836.460

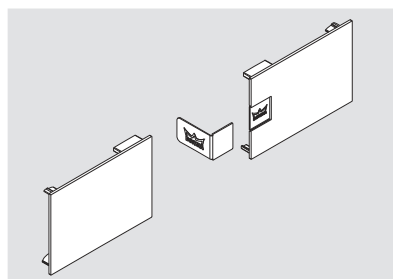

Premium XL 120 Self-Closing endcaps

Set endcaps for XL 120 SC for wall and ceiling installation

Ref. No. 836.656

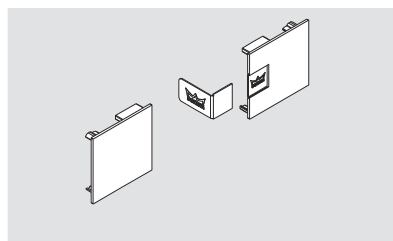

Comfort L 80 endcaps

Set endcaps for wall and ceiling installation for L 80 DM and L 80

Ref. No. 836.354

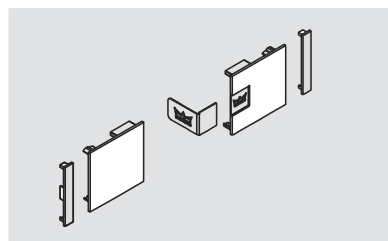

Comfort L 80 glass mount endcaps

Set endcaps for installation on glass for L 80 DM and L 80

Ref. No. 836.260

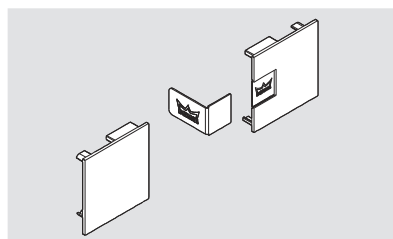

Comfort M 50 endcaps

Endcaps set for use with M50 or M 50 with optional DM

Ref. No. 836.152

DORMOTION accessories

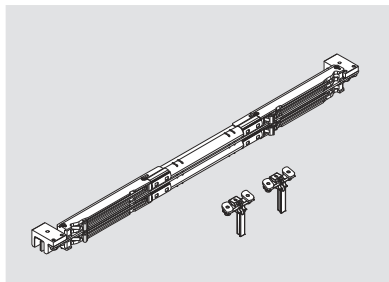

**Premium XL 150
DORMOTION unit**
DORMOTION unit for
max. 330 lb (150 kg),
with set of DM start/
stops (min glass width
40-1/8" [1020])

Ref. No. 836.558

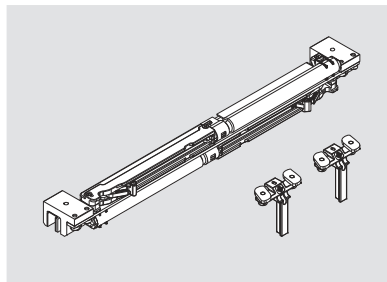

**Premium XL 80
DORMOTION unit**
DORMOTION unit for
max. 176 lb (80 kg),
with set of DM start/
stops (min glass width
31-7/8" [810])

Ref. No. 836.557

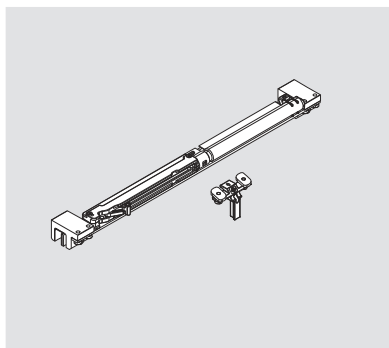

**Premium XL 120
DORMOTION unit**
for Self-Closing function
(closing direction only)
for max 264 lb (120 kg)
with DM start/stop

Opening to right side (RH)

Ref. No. 836.660

Opening to left side (LH)

Ref. No. 836.661

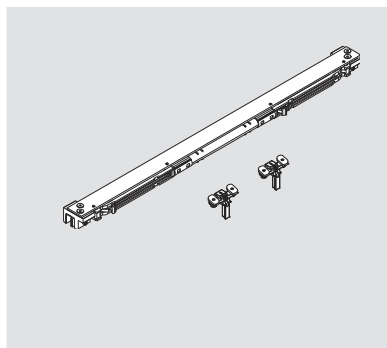

**Comfort L 80
DORMOTION unit**
L 80 DORMOTION
spring cushioning unit
for max 176 lb (80 kg)
with set of start/stops

Ref. No. 836.355

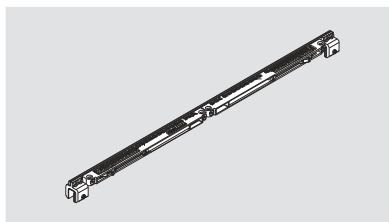

Comfort M 50 DM set
Optional DORMOTION
unit, incl. DM start/stop

Ref. No. 836.153

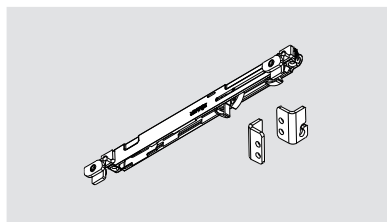

**Premium XL 120 SC
DMSC Accessory Set**
Includes DORMOTION
Cushion and 1 DM
start/stop

Ref. No. 836.666

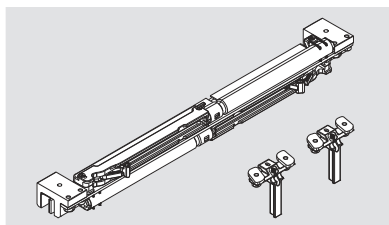

**Premium XL 80 TEL DM
Accessory Set**
Includes DORMOTION
Cushion and 2 DM start/
stops

Ref. No. 836.786

DORMOTION start/stop kits

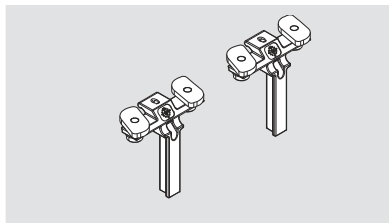

**Premium XL DM start/
stop set**
DORMOTION start/stop
set

Ref. No. 836.559

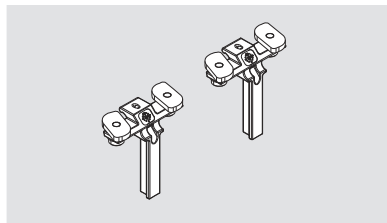

**Comfort L 80 DM
start/stop set**
L 80 DORMOTION
start/stop set

Ref. No. 836.356

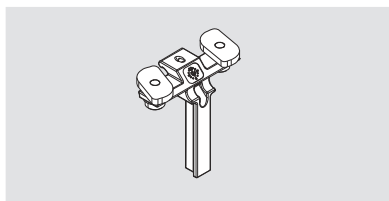

**Premium XL 120 Self-
Closing start/stop**
For Self-Closing
DORMOTION
One piece service part

Ref. No. 836.662

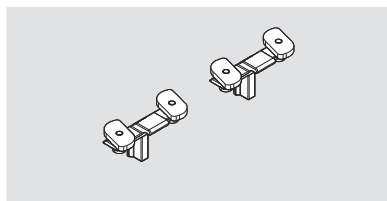

**Comfort M 50 DM
start/stop set**
Service part

Ref. No. 836.154

Component parts

Synchro accessories

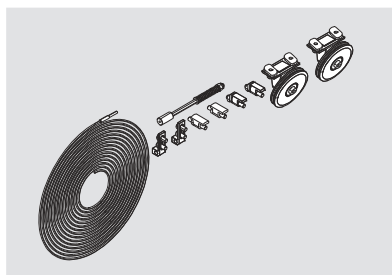

Premium XL 150 Synchro set (wire, pulley etc.)

Synchro set complete with accessories (Not compatible with XL 150 DM)

Ref. No. 836.560



Comfort Synchro service wire

Replacement wire for Synchro set

Ref. No. 836.358



Comfort L 80 Synchro set (wire, pulley etc.)

Synchro set complete with accessories

Ref. No. 836.357



Premium XL 80 TEL service cable

Replacement wire; not compatible with Synchro Cable

(Extended lead-time)

Ref. No.
836.515.001.55 (LH)
836.515.002.55 (RH)

Self-Closing accessories

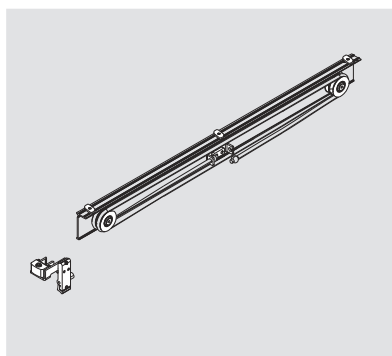

Premium XL 120 Self-Closing assembly

Flexi-cable unit for Self-Closing function, complete with accessories

Opening to right side (RH)

Ref. No. 836.657

Opening to left side (LH)

Ref. No. 836.658

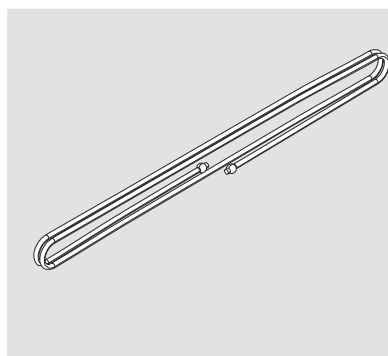

Premium XL 120 Self-Closing flexi-cable

Flexi-cable for Self-Closing function

Service part

Ref. No. 836.659

Brush profiles

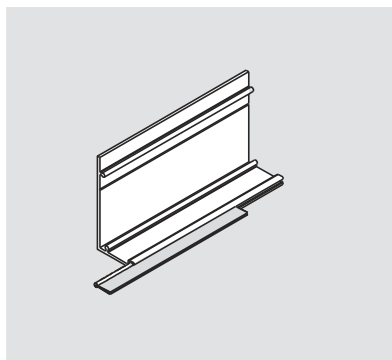

Comfort brush profile

Brush profile (slides into cover groove)

Specify length (by ft.)

for 5/16" – 3/8"
(8 – 10) glass

Ref. No. 836.912

for 1/2" – 9/16"
(12 – 13.5) glass

Ref. No. 836.913

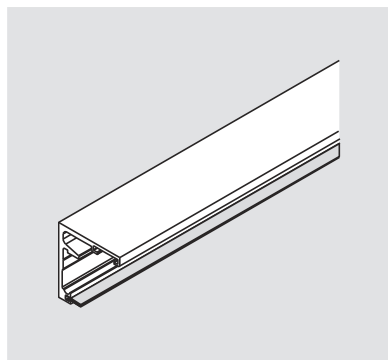

Comfort cover brush

Brush profile for 5/16" – 3/8" (8 – 10)

Ref. No. 807.424

Note: For M 50, brush attaches to track.

Component parts

Endstops

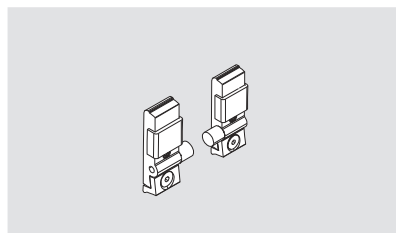

Premium XL 150/120/80 endstops

Endstop set, 2 pieces, for use with XL 150 DM, XL 150, XL 120 SC, XL 80 DM

Ref. No. 836.465

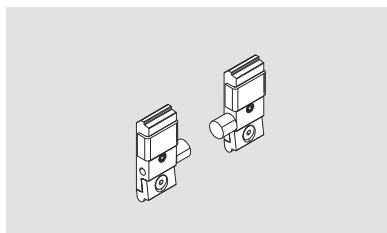

Comfort L 80 endstop set

Endcap set
2 pieces for use with L 80 DM or L 80

Ref. No. 836.267

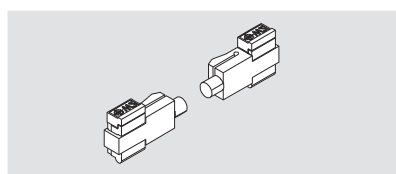

Comfort M 50 endstops

Endstop set, 2 pieces for use with M 50 or M 50 with optional DM

Ref. No. 836.158

Bumper sets

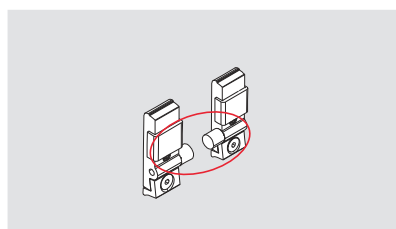

Premium XL 150/120/80 bumper set

Set of 2 bumpers; used in endstops for XL 150/120/80

Ref. No. 836.466

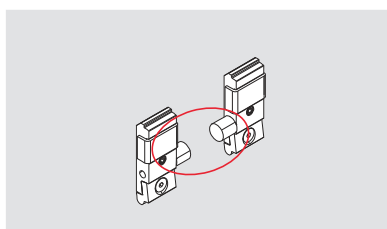

Comfort L 80 bumper set

Set of 2 bumpers; used in endstops for L 80 DM or L 80

Ref. No. 836.268

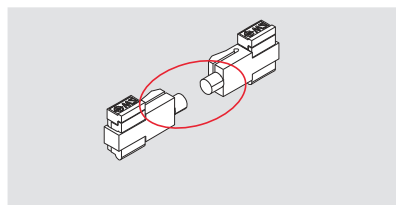

Comfort M 50 bumper set

Set of 2 bumpers; used in endstops for M 50 or M 50 with optional DM

Ref. No. 836.159

Holder hook sets

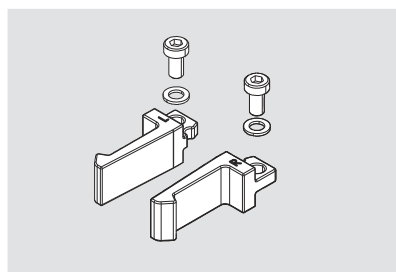

Premium XL 150 hook set

Hook set, 2 pieces, for use with XL 150; attaches to roller carrier (Not compatible with XL 150 DM or XL 80 DM)

Ref. No. 836.467

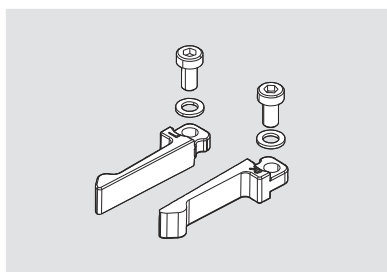

Comfort L 80 hook set

Hook set, 2 pieces, for use with L 80 (not compatible with DM)

Ref. No. 836.269

Component parts

Sidelite (fixed panel) extrusions and accessories

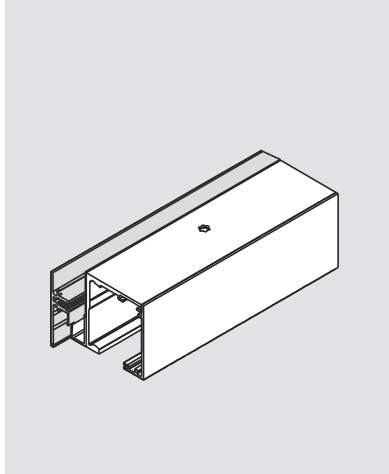

Premium XL sidelite profile

Sidelite profile (2-3/4" [69] high) for sidelite connection at top. Complete with all gaskets. For use with XL 150 DM, XL 150, XL 120 SC, XL 80 DM

Fixed length
157-1/2" (4000)

Ref. No. 936.469

Specify length (by ft.)

Ref. No. 836.474

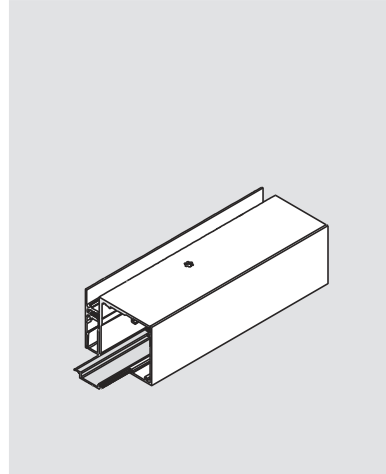

Comfort sidelite view protection profile

Use sidelite profile with XL or L systems 2-5/16" + 2-3/4" (58 + 69) high

Fixed length
157-1/2" (4000)

Ref. No. 936.800

Specify length (by ft.)

Ref. No. 836.801

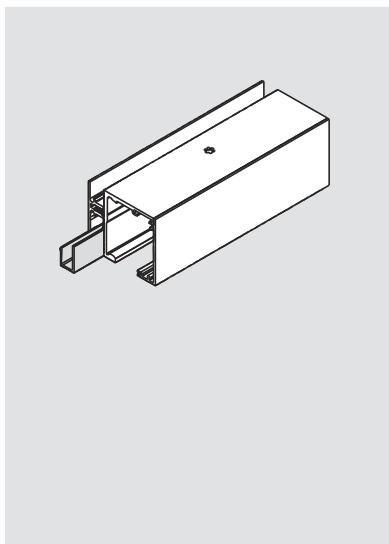

Comfort sidelite filling profile

For use with XL or L sidelite profile

2-5/16" + 2-3/4" (58 + 69) high

Fixed length
157-1/2" (4000)

Ref. No. 936.802

Specify length (by ft.)

Ref. No. 836.803

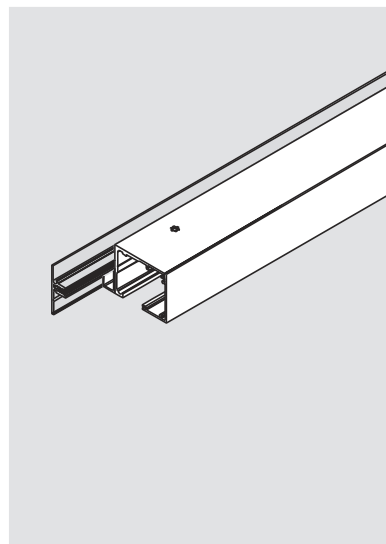

Comfort L 80 sidelite profile

Sidelite profile for sidelite connection at top for use with L 80 DM and L 80, 2-5/16" (58) high, complete with all gaskets; for 5/16" – 9/16" (8 – 13.5) thick glass.

Fixed length
157-1/2" (4000)

Ref. No. 936.272

Specify length (by ft.)

Ref. No. 836.274

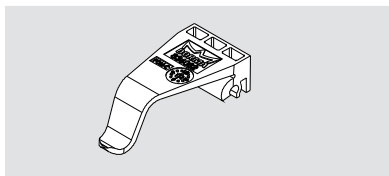

View profile clip

For use with view profile extrusion for Sidelite application

Ref. No. 836.891

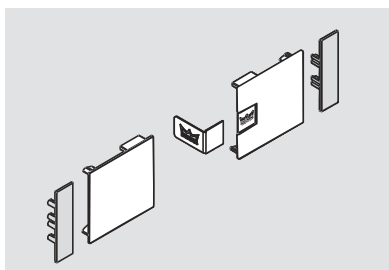

Premium XL sidelite endcaps

Set endcaps for sidelite profile for use with all XL systems

2-3/4" (69) high

Ref. No. 836.471

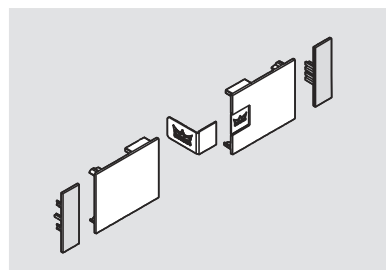

Comfort L 80 sidelite endcaps

Set endcaps for sidelite profile

2-5/16" (58) high

Ref. No. 836.273

Component parts

Sidelite (fixed panel) extrusions and accessories

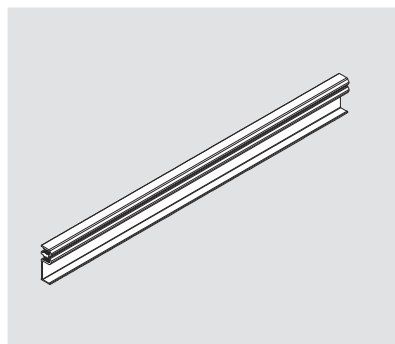

Comfort 150/120/80 drop ceiling connector profile

Incl. extrusion and fasteners

Fixed length
157-1/2" (4000)

Ref. No. 836.821

Specify length (by ft.)
Ref. No. 836.820

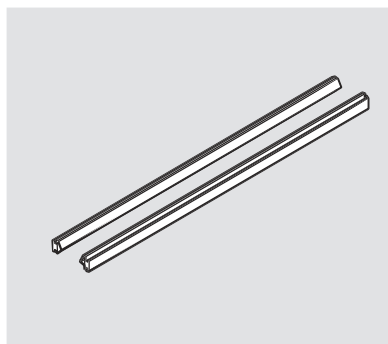

U-Channel gaskets

Gasket for 1/2" (12-13.5) thick glass

Specify length (by ft.)

Ref. No. 925.147

Gasket for 3/8" (10) thick glass

Specify length (by ft.)
Ref. No. 925.148

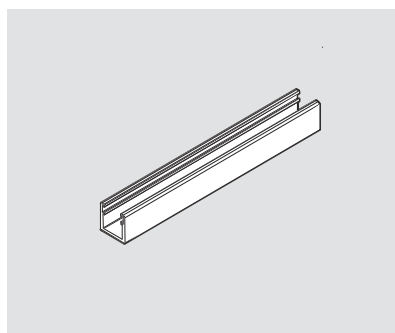

Dri-Fit® pre-drilled U-Channel

Connecting profile for fixed panel (sidelite) fixing

Profile for 3/8" - 1/2" (10 - 13) thick glass

Specify length (by ft.)
Ref. No. 925.447

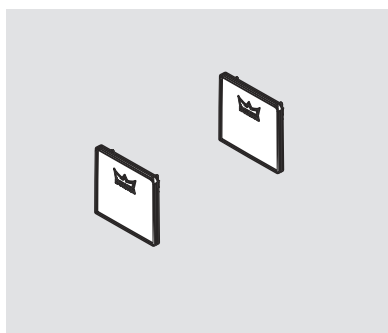

U-Channel endcaps

Set endcaps for Ref. No. 925.447

Ref. No. 925.121

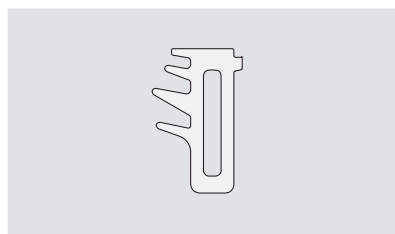

Sidelite profile gasket

5/16"-3/8" (8-10) thick glass; black

Ref. No. 836.195



Sidelite profile gasket

3/8"-1/2" (10-13) thick glass; black

Ref. No. 836.196

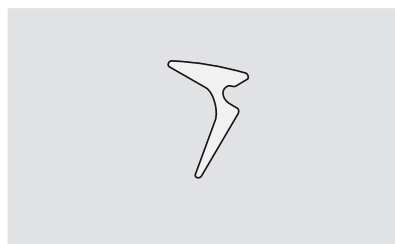

Sidelite profile gasket

1/2"-17/32" (13-13.5) thick glass; black

Ref. No. 836.197

Component parts

Recessed mount (CE-R) accessories

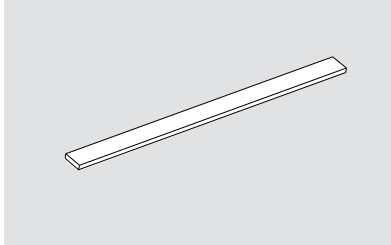

Foam, adhesive back
3/16" (5) vinyl
Supplied optional for
CE-R units, 50 ft. Roll
Grey

Ref. No. 933.915

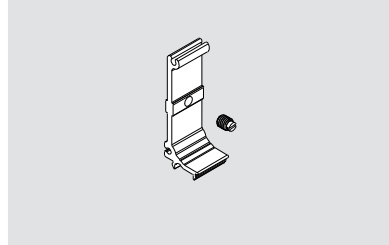

**XL Premium recessed
cover clip**

Ref. No. 936.145

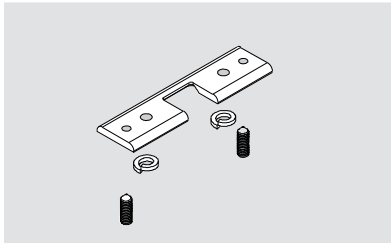

**XL Premium recessed
Start/Stop service plate**

Ref. No. 936.561

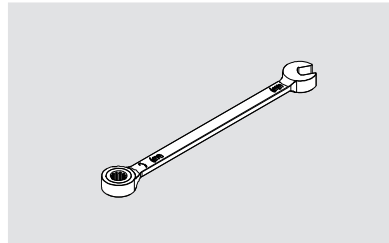

**Wrench, 6MM
ratcheting / combo**

Use with
Ref. No. 936.898 and
Ref. No. 936.899
hex bit in CE-R units

Ref. No. 936.897

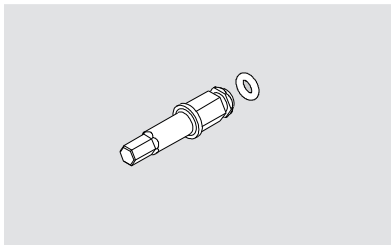

M4 Long Hex Bit
Recessed mount service
item

Ref. No. 936.898

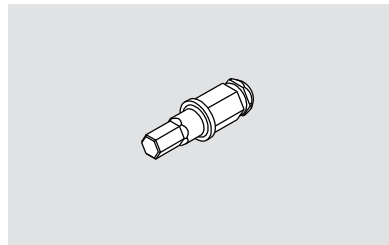

M4 Short Hex Bit
Recessed mount
service item

Ref. No. 936.899

Status indicator

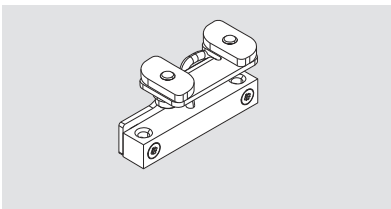

MUTO status indicator
Status indicator set,
complete with
accessories (sensor,
cable, etc.)

Ref. No. 836.840

Component parts

Tempered Laminated Glass (TLG) accessories



TLG applicator (LGAA)

3M™ Scotch-Weld™
EPX™ plus II applicator
with 2:1 and 1:1 plunger

Ref. No. 934.801



TLG mixing nozzle (MTIPS)

3M™ Scotch-Weld™
Urethane Adhesive, DP
605 NS, off white,
1 tube per 4 roller
carriers

Ref. No. 934.805



TLG adhesive (LGA)

3M™ Scotch-Weld™
EPX™ plus II mixing
square nozzle, 5.3 mm
(4 tips per set)

Ref. No. 934.800

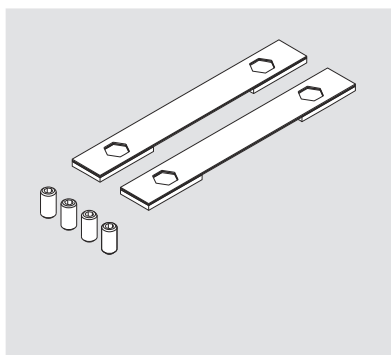

Premium XL 150 Tempered Laminated Glass (TLG) roller gasket

Accessory set for use
with TLG for one pair of
clamp carriers

Requires optional
adhesive components

Ref. No. 836.468

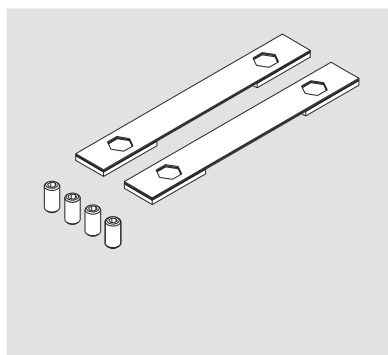

Comfort L 80 Tempered Laminated Glass (TLG) roller gasket

Accessory set for use
with TLG for one pair
of clamp carriers

Requires optional
adhesive components

Ref. No. 836.270

Installation accessories



MUTO carrier locating tool

Accessory tool for
quickly and easily
locating roller carrier on
top of moving panel

Ref. No. 936.999



MUTO tool kit

Accessory tool kit,
incl. typical tools used
for installation and
adjustment of MUTO
Comfort systems

Ref. No. 936.996



www.dormakaba.us

dormakaba USA Inc.
Dorma Drive, Drawer AC
Reamstown, PA 17567
800.523.8483

dormakaba Canada Inc.
1680 Courtney Park Drive
Unit 13
Mississauga, ON L5T 1R4
800.387.4938